

Section 1

# Schedule 80 PVC Piping Systems

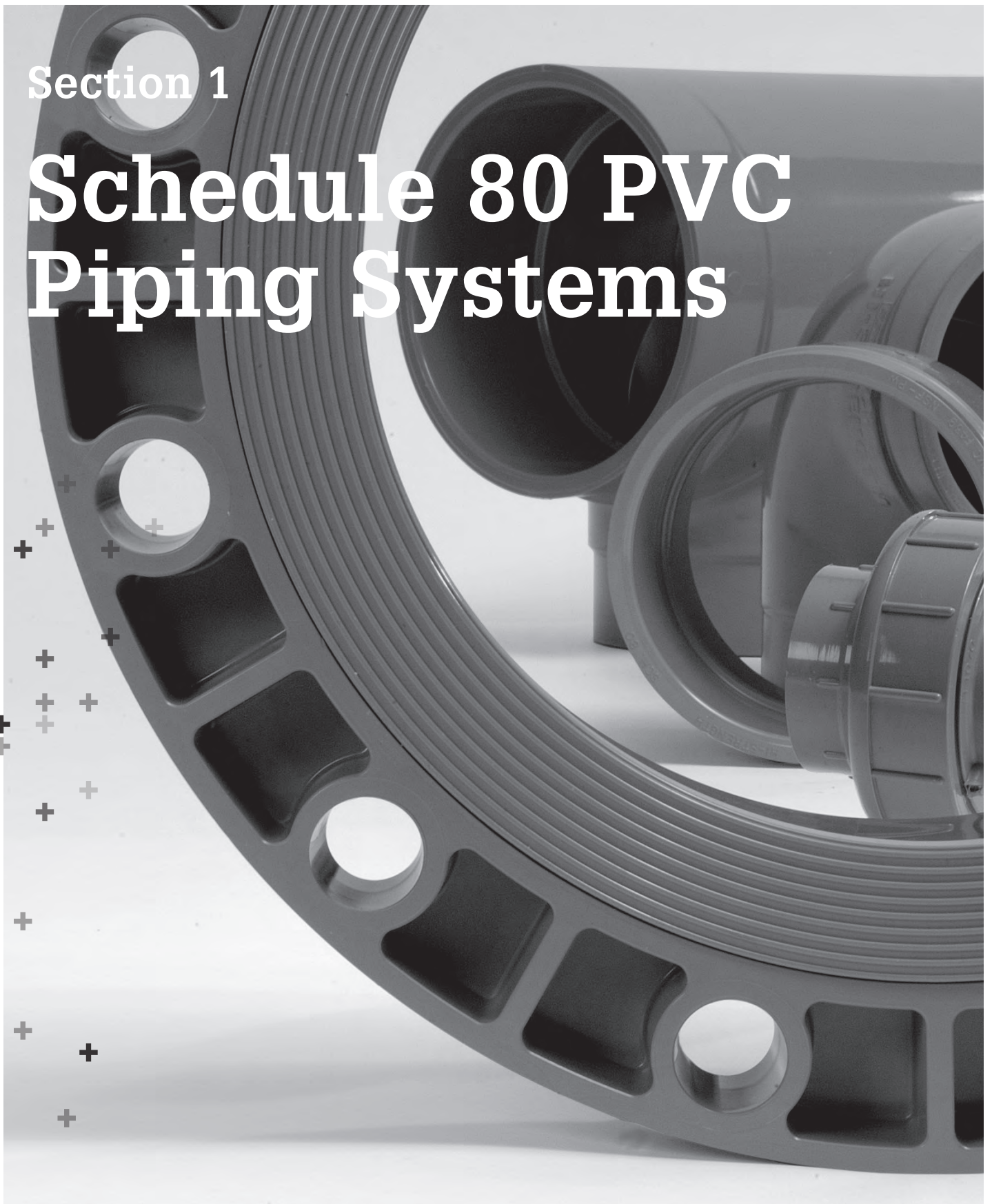

## Glossary

<b>FPT</b>	=	<b>Female Pipe Thread</b>
<b>MPT</b>	=	<b>Male Pipe Thread</b>
<b>S</b>	=	<b>Tapered Socket</b>
<b>SPG</b>	=	<b>Spigot End (same dimension as pipe outside diameter)</b>
<b>*</b>	=	<b>Non-Returnable / Non-cancellable</b>
<b>^</b>	=	<b>40% Restocking Fee</b>
<b>HS</b>	=	<b>High Strength Design</b>
<b>SL</b>	=	<b>Streamline Design</b>
<b>BUSH</b>	=	<b>Assembled Fitting from Molded Components</b>
<b>FAB</b>	=	<b>Fabricated Fitting</b>

The technical information given in this publication implies no warranty of any kind and is subject to change without notice. Please consult our Terms and Conditions of Sale.

For complete technical information, please consult the GF Harvel Engineering and Installation Guide available online at [www.gfpiping.com/resource.html](http://www.gfpiping.com/resource.html) [see "Technical Docs"] or by calling (800) 854-4090.

**For more information about any of our product lines, please call (800) 854-4090.**



Harvel® Industrial PVC Pressure Pipe

5

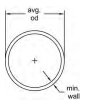

Harvel® Industrial PLUS PVC Pressure Pipe

6



Schedule 80 PVC Pressure Fittings

7



Schedule 80 PVC Low Pressure Fittings

31



Schedule 80 PVC DWV Fittings

33



Schedule 80 PVC Metal Transition Fittings

37



Schedule 80 PVC Expansion Joints

39

# Specifications, Standards and Tolerances

## Specifications and Standards

NSF/ANSI Standard 14

NSF/ANSI Standard 61

ASTM D 1784	:	Material PVC Type I, Grade I Gray (cell classification 12454)
ASTM D 1785	:	PVC Schedule 80 Pipe
ASTM D 2467	:	PVC Schedule 80 Socket & Threaded Fittings
ASTM D 2464	:	PVC Schedule 80 Threaded Fittings
ASTM F 1498	:	PVC Schedule 80 Taper Threads
ASTM D 2672	:	PVC Schedule 80 Tapered Sockets for Bell End Pipe
ASTM F 1970	:	PVC Schedule 80 Unions
ANSI B16.5	:	Outside Diameter & Flange Bolt Hole Patterns
ANSI B1.20.1	:	PVC Schedule 80 NPT Threads
CSA B137.3	:	PVC Schedule 80 Pipe

## Molded Dimension Tolerances

A	Piston Position; Expansion Joints : $\pm 0.03$
D	Outside Diameter : $\pm 0.06$
G, G1	Intersections of centerlines to bottom of socket; 90° Ells, Tees : up to 4" $\pm 0.03$ ; 6" and above $\pm 0.06$
GJ, GN	Intersections of centerlines to bottom of socket; 45° Wyes : up to 4" $\pm 0.03$ ; 6" and above $\pm 0.06$
H, HJ, HN	Intersections of centerlines to face of fitting; 90° Ells, 45° Ells, Tees, 45° Wyes : up to 4" $\pm 0.03$ ; 6" and above $\pm 0.06$
HL	Socket Bottom to Face of Fitting : up to 4" $\pm 0.03$ ; 6" and above $\pm 0.06$
J	Intersections of centerlines to bottom of socket; 45° & 30° Ells : up to 4" $\pm 0.03$ ; 6" and above $\pm 0.06$
L	Overall Length of fitting : $\pm 0.06$
N	Socket Bottom to Socket Bottom; Couplings, Unions : $\pm 0.06$
N1	Socket Bottom to Face of Flange : $\pm 0.06$
R	Thickness on Plugs, Flanges : $\pm 0.03$
T, T1	Effective Thread Length : Reference Only
W	Height of Cap : $\pm 0.06$

# Harvel® Industrial PVC Pressure Pipe

\*

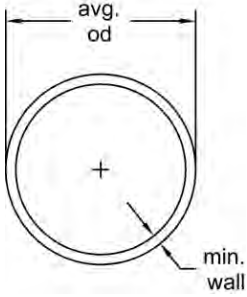

## Plain End Pipe - 20 ft lengths

- Refer to Industrial PLUS for sizes 1/8", 1/4", 3/8", 3-1/2", 5", 14"-24"
- Max Water Pressure at 73°F (22.7°C) with solvent-cemented joints
- Meets NSF<sup>®</sup>-pw-G
- Non - CSA Approved

Size (inch)	P/L	Plain End Part No.	USD
1/2	H18	*H0800050PG2000	2.41
3/4	H18	*H0800075PG2000	3.19
1	H18	*H0800100PG2000	4.81
1 1/4	H18	*H0800125PG2000	6.65
1 1/2	H18	*H0800150PG2000	7.52
2	H18	*H0800200PG2000	10.40
2 1/2	H18	*H0800250PG2000	17.47
3	H18	*H0800300PG2000	21.43
4	H18	*H0800400PG2000	30.83
6	H18	*H0800600PG2000	59.47
8	H18	*H0800800PG2000	89.47
10	H18	*H0801000PG2000	132.70
12	H18	*H0801200PG2000	181.57

Lift Qty. (20ft Lgths) (ft)	Average O.D. (inch)	Min. Wall (inch)	Wt/Ft (lbs/ft)	Max Water Pressure (psi)
5700	0.840	0.147	0.202	850
5260	1.050	0.154	0.273	690
4280	1.315	0.179	0.402	630
2360	1.660	0.191	0.554	520
2060	1.900	0.200	0.673	470
1660	2.375	0.218	0.932	400
1080	2.875	0.276	1.419	420
840	3.500	0.300	1.903	370
520	4.500	0.337	2.782	320
340	6.625	0.432	5.313	280
220	8.625	0.500	8.058	250
80	10.750	0.593	11.956	230
60	12.750	0.687	16.437	230

\*

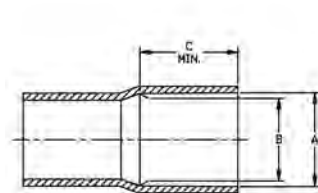

## Belled End Pipe - 20 ft lengths

Size (inch)	P/L	Belled End Part No.	USD	A-Socket Entrance (Belled Pipe)	B-Socket Bottom (Belled Pipe)	C-Min. (Belled Pipe)
1/2	H18	*H0800050PG200B	2.54	0.848±0.004	0.836±0.004	1.000
3/4	H18	*H0800075PG200B	3.37	1.058±0.004	1.046±0.004	1.250
1	H18	*H0800100PG200B	5.06	1.325±0.005	1.310±0.005	1.500
1 1/4	H18	*H0800125PG200B	7.00	1.678±0.002	1.653±0.005	1.870
1 1/2	H18	*H0800150PG200B	7.91	1.910±0.004	1.884±0.004	2.000
2	H18	*H0800200PG200B	10.94	2.387±0.006	2.369±0.006	2.250
2 1/2	H18	*H0800250PG200B	18.39	2.889±0.007	2.868±0.007	2.500
3	H18	*H0800300PG200B	22.56	3.516±0.008	3.492±0.008	3.250
4	H18	*H0800400PG200B	32.45	4.518±0.009	4.491±0.009	4.000
6	H18	*H0800600PG200B	62.60	6.647±0.011	6.614±0.011	6.000
8	H18	*H0800800PG200B	94.19	8.655±0.015	8.610±0.015	6.000
10	H18	*H0801000PG200B	139.69	10.776±0.015	10.737±0.015	8.000
12	H18	*H0801200PG200B	191.12	12.778±0.015	12.736±0.015	8.500

# Harvel® Industrial PLUS PVC Pressure Pipe

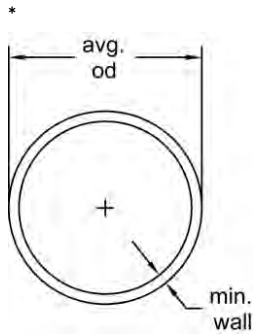

## Plain End Pipe - 20 ft lengths

- Meets NSF®-pw-G
- Meets CAN/CSA B137.3 Requirements

Size (inch)	P/L	Plain End Part No.	USD	Lift Qty. (20ft Lgths) (ft)	Average O.D. (inch)	Min. Wall (inch)	Wt/Ft (lbs/ft)	Max Water Pressure (psi)
¼	H50	* H0800013PG2000	2.98	5700	0.405	0.095	0.058	1230
¼	H50	* H0800025PG2000	4.99	5700	0.540	0.119	0.100	1130
⅜	H50	* H0800038PG2000	7.39	5700	0.675	0.126	0.138	920
½	H50	* HX800050PG2000	2.68	5700	0.840	0.147	0.202	850
¾	H50	* HX800075PG2000	3.54	5260	1.050	0.154	0.273	690
1	H50	* HX800100PG2000	5.34	4280	1.315	0.179	0.402	630
1 ¼	H50	* HX800125PG2000	7.39	2360	1.660	0.191	0.554	520
1 ½	H50	* HX800150PG2000	8.35	2060	1.900	0.200	0.673	470
2	H50	* HX800200PG2000	11.55	1660	2.375	0.218	0.932	400
2 ½	H50	* HX800250PG2000	19.42	1080	0.287	0.276	1.419	420
3	H50	* HX800300PG2000	23.82	840	3.500	0.300	1.903	370
3 ½	H50	* H0800350PG2000	38.21	680	4.000	0.318	2.322	350
4	H50	* HX800400PG2000	34.25	520	4.500	0.337	2.782	320
5	H50	* H0800500PG2000	48.65	400	5.563	0.375	3.867	290
6	H50	* HX800600PG2000	66.08	340	6.625	0.432	5.313	280
8	H50	* HX800800PG2000	99.41	220	8.625	0.500	8.058	250
10	H50	* HX801000PG2000	147.44	80	10.750	0.593	11.956	230
12	H50	* HX801200PG2000	201.74	60	12.750	0.687	16.437	230
14	H50	* H0801400PG2000	260.55	60	14.000	0.750	19.790	220
16	H50	* H0801600PG2000	414.03	60	16.000	0.843	25.430	220
18	H50	* H0801800PG2000	506.65	40	18.000	0.937	31.830	220
20	H50	* H0802000PG2000	554.61	40	20.000	1.031	40.091	220
24	H50	* H0802400PG2000	821.57	40	24.000	1.218	56.882	210

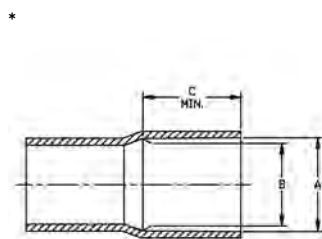

## Belled End Pipe - 20 ft lengths

Size (inch)	P/L	Belled End Part No.	USD	A-Socket Entrance (Belled Pipe)	B-Socket Bottom (Belled Pipe)	C-Min. (Belled Pipe)
½	H50	* HX800050PG200B	2.82	0.848±0.004	0.836±0.004	1.000
¾	H50	* HX800075PG200B	3.74	1.058±0.004	1.046±0.004	1.250
1	H50	* HX800100PG200B	5.62	1.325±0.005	1.310±0.005	1.500
1 ¼	H50	* HX800125PG200B	7.78	1.670±0.005	1.655±0.005	1.750
1 ½	H50	* HX800150PG200B	8.79	1.912±0.006	1.894±0.006	2.000
2	H50	* HX800200PG200B	12.16	2.387±0.006	2.363±0.006	2.250
2 ½	H50	* HX800250PG200B	20.45	2.889±0.007	2.861±0.007	2.500
3	H50	* HX800300PG200B	25.05	3.516±0.008	3.484±0.008	3.250
3 ½	H50	* H0800350PG200B	40.22	4.016±0.008	3.984±0.008	3.500
4	H50	* HX800400PG200B	36.05	4.518±0.009	4.482±0.009	4.000
5	H50	* H0800500PG200B	51.20	5.583±0.010	5.543±0.010	4.000
6	H50	* HX800600PG200B	69.55	6.647±0.011	6.603±0.011	6.000
8	H50	* HX800800PG200B	104.65	8.655±0.015	8.598±0.015	6.000
10	H50	* HX801000PG200B	155.20	10.776±0.015	10.722±0.015	7.500
12	H50	* HX801200PG200B	212.36	12.778±0.015	12.721±0.015	8.500
14	H50	* H0801400PG200B	274.16	14.035±0.015	13.985±0.015	9.000
16	H50	* H0801600PG200B	435.81	16.045±0.015	15.980±0.015	10.000
18	H50	* H0801800PG200B	527.78	18.055±0.020	17.980±0.020	12.000
20	H50	* H0802000PG200B	577.75	20.065±0.025	19.980±0.025	12.000
24	H50	* H0802400PG200B	855.80	24.075±0.030	23.970±0.030	12.000



# Schedule 80 PVC Pressure Fittings

## Tee (S x S x S)

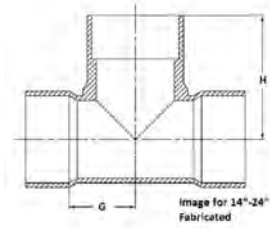
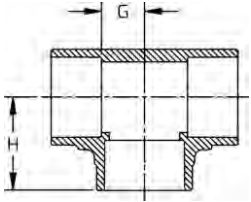

Size (inch)	P/L	Part No.	USD	Pack Qty	H (inch)	G (inch)	Design
¼	608	* 801-002	10.94	50	0.95	0.27	HS
⅜	608	* 801-003	10.94	50	1.16	0.38	HS
½	608	801-005	10.33	25	1.41	0.51	SL
¾	608	801-007	10.82	25	1.60	0.58	SL
1	608	801-010	13.54	20	1.85	0.71	SL
1 ¼	608	801-012	37.20	10	2.17	0.91	SL
1 ½	608	801-015	37.20	10	2.43	1.04	SL
2	608	801-020	46.51	10	2.81	1.30	SL
2 ½	608	801-025	50.57	5	3.31	1.55	SL
3	608	801-030	63.20	5	3.71	1.81	SL
4	608	801-040	73.23	5	4.60	2.33	SL
5	H02	* 801-050S	178.62	1	5.78	3.16	SL
6	608	801-060	250.04	2	6.53	3.51	SL
8	608	801-080	579.92	1	8.66	4.58	SL
10	602	801-100	1,915.92	1	10.79	5.78	SL
12	602	801-120	2,705.81	1	12.96	6.94	SL
14	A33	* 801-140N	2,873.63	1	19.50	10.88	FAB
16	A33	* 801-160N	3,736.58	1	22.75	12.13	FAB
18	A33	* 801-180N	4,451.11	1	26.00	13.38	FAB
20	A33	* 801-200N	5,738.56	1	28.25	14.63	FAB
24	A33	* 801-240N	7,626.73	1	34.50	17.13	FAB

## Reducing Tee (S x S x S)

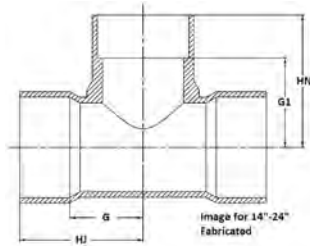
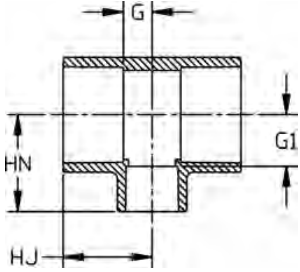

Size (inch)	P/L	Part No.	USD	Pack Qty	HJ (inch)	HN (inch)	G (inch)	G1 (inch)	Design
¾ x ½	608	801-101	7.92	25	1.62	1.62	0.60	0.72	SL
1 x ½	608	801-130	11.44	25	1.87	1.64	0.72	0.74	SL
1 x ¾	608	801-131	11.44	20	1.86	1.89	0.72	0.75	SL
1 ¼ x ½	608	* 801-166FB	31.56	20	1.99	2.35	0.73	1.47	BUSH
1 ¼ x ¾	608	* 801-167FB	24.83	20	1.99	2.35	0.73	1.33	BUSH
1 ½ x 1	608	801-168	24.83	20	2.01	2.05	0.73	0.91	SL
1 ½ x ½	608	801-209	24.83	5	1.92	1.91	0.53	1.03	SL
1 ½ x ¾	608	801-210	24.83	5	1.99	2.07	0.60	1.05	SL
1 ½ x 1	608	801-211	24.83	5	2.12	2.17	0.72	1.03	SL
1 ½ x 1 ¼	608	* 801-212FB	24.83	5	2.44	2.74	1.04	1.47	BUSH
2 x ½	608	801-247	31.46	5	1.99	2.16	0.54	1.28	SL
2 x ¾	608	801-248	31.46	5	2.22	2.31	0.60	1.30	SL
2 x 1	608	801-249	31.46	5	2.24	2.42	0.72	1.27	SL
2 x 1 ¼	608	* 801-250FB	47.97	5	2.81	3.11	1.30	1.84	BUSH
2 x 1 ½	608	801-251	31.46	5	2.54	2.66	1.03	1.27	SL
2 ½ x ½	608	* 801-287FB	48.09	5	3.05	3.35	1.28	2.44	BUSH
2 ½ x ¾	608	* 801-288FB	48.09	5	3.05	3.35	1.28	2.33	BUSH
2 ½ x 1	608	* 801-289FB	39.00	5	3.05	3.36	1.28	2.22	BUSH
2 ½ x 1 ¼	608	* 801-290FB	41.05	5	3.05	3.34	1.28	2.07	BUSH
2 ½ x 1 ½	608	* 801-291FB	41.05	5	3.05	3.35	1.28	1.94	BUSH
2 ½ x 2	608	801-292	41.05	5	3.05	3.05	1.28	1.54	SL
3 x ½	608	* 801-333FB	57.67	5	3.20	3.68	1.30	2.77	BUSH
3 x ¾	608	* 801-334FB	65.08	5	3.20	3.68	1.30	2.66	BUSH
3 x 1	608	* 801-335FB	54.79	5	3.20	3.69	1.30	2.55	BUSH
3 x 1 ¼	608	* 801-336FB	57.67	5	3.20	3.67	1.30	2.40	BUSH
3 x 1 ½	608	* 801-337FB	57.67	5	3.20	3.68	1.30	2.27	BUSH
3 x 2	608	801-338	57.67	5	3.20	3.39	1.30	1.87	SL
3 x 2 ½	608	* 801-339FB	57.67	5	3.73	4.07	1.81	2.17	BUSH
4 x ½	608	* 801-415FB	114.07	5	3.52	4.19	1.27	3.28	BUSH
4 x ¾	608	* 801-416FB	114.07	5	3.52	4.19	1.27	3.17	BUSH
4 x 1	608	801-417	114.07	5	2.99	3.49	2.99	3.49	SL
4 x 1 ¼	608	* 801-418FB	114.07	5	3.52	4.18	1.27	2.91	BUSH
4 x 1 ½	608	* 801-419FB	93.20	5	3.52	4.19	1.27	2.78	BUSH
4 x 2	608	801-420	93.20	5	3.54	3.87	1.27	2.37	SL
4 x 2 ½	608	* 801-421FB	167.78	5	4.14	4.62	1.85	2.73	BUSH
4 x 3	608	801-422	93.20	5	4.13	4.26	1.85	2.35	SL
5 x ½	H02	* 801-484S	402.87	1	5.81	6.91	3.16	5.53	SL
5 x 3	H02	* 801-488S	350.54	1	5.81	6.50	3.16	4.63	SL
5 x 4	H02	* 801-490S	278.05	1	5.81	6.16	3.16	3.91	SL
6 x ½	608	* 801-523FB	242.38	2	6.56	7.42	3.56	6.52	BUSH
6 x ¾	608	* 801-524FB	242.38	2	6.56	7.43	3.49	6.41	BUSH
6 x 1	608	* 801-525FB	186.23	2	6.56	7.44	3.49	6.29	BUSH
6 x 1 ¼	608	* 801-526FB	242.38	2	6.56	7.42	3.49	6.15	BUSH
6 x 1 ½	608	* 801-527FB	242.38	2	6.56	7.42	3.49	6.02	BUSH
6 x 2	608	801-528	Call	2	4.45	5.25	1.43	3.74	SL
6 x 2 ½	608	* 801-529FB	242.18	2	6.56	7.52	3.49	5.62	BUSH
6 x 3	608	* 801-530FB	186.23	2	6.56	7.21	3.49	5.25	BUSH
6 x 4	608	801-532	250.04	2	6.57	6.80	3.49	4.47	HS
6 x 5	H04	* 801-533FS	526.33	1	9.00	9.50	5.75	6.50	FAB
8 x 4	608	801-582	677.03	2	8.41	8.53	4.29	6.30	SL
8 x 5	H04	* 801-583FS	673.76	1	10.50	10.44	6.25	7.44	FAB
8 x 6	608	801-585	579.92	1	7.65	7.54	3.55	4.63	SL
10 x 1 ½	A33	801-618N	Call	1	10.75	12.45	5.75	11.04	FAB
10 x 2	A33	* 801-619N	697.62	1	10.75	11.50	5.75	9.50	FAB
10 x 3	A33	* 801-621N	748.19	1	10.75	11.50	5.25	9.50	FAB
10 x 4	A33	* 801-623N	775.11	1	10.75	11.50	5.75	9.50	FAB
10 x 6	602	* 801-626FB	1,686.02	1	10.83	11.43	5.78	8.33	BUSH
10 x 6	A33	* 801-626N	876.60	1	11.88	12.50	6.88	9.50	FAB
10 x 8	602	* 801-628FB	1,984.22	1	10.83	11.46	5.78	7.36	BUSH
10 x 8	A33	* 801-628N	983.41	1	13.00	13.50	8.00	9.50	FAB
12 x 2	A33	* 801-659N	902.09	1	12.00	12.75	6.00	10.75	FAB

table continued on the next page



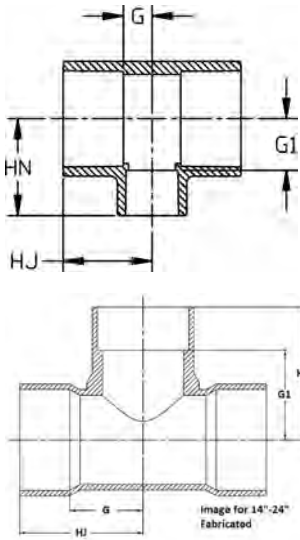

Size (inch)	P/L	Part No.	USD	Pack Qty	HJ (inch)	HN (inch)	G (inch)	G1 (inch)	Design
12 x 3	A33	* 801-661N	971.74	1	12.00	12.75	6.00	10.75	FAB
12 x 4	A33	* 801-663N	1,030.83	1	12.00	12.75	6.00	10.75	FAB
12 x 6	A33	* 801-666N	1,138.24	1	13.13	13.75	7.13	10.75	FAB
12 x 8	602	* 801-668FB	2,508.29	1	12.99	13.67	6.94	9.58	BUSH
12 x 8	A33	* 801-668N	1,221.18	1	14.13	14.75	8.13	10.75	FAB
12 x 10	602	* 801-670FB	3,358.95	1	12.99	13.68	6.94	8.57	BUSH
12 x 10	A33	* 801-670N	1,356.99	1	15.13	15.75	9.13	10.75	FAB
14 x 2	A33	* 801-692N	1,130.32	1	13.13	13.50	6.13	11.50	FAB
14 x 3	A33	* 801-694N	1,387.71	1	12.63	13.50	6.13	11.50	FAB
14 x 4	A33	* 801-696N	1,529.26	1	13.13	13.50	6.13	11.50	FAB
14 x 6	A33	* 801-698N	1,650.83	1	14.25	14.50	7.25	11.50	FAB
14 x 8	A33	* 801-700N	1,735.95	1	15.25	15.50	8.25	11.50	FAB
14 x 10	A33	* 801-702N	1,854.57	1	16.25	16.50	9.25	11.50	FAB
14 x 12	A33	* 801-704N	1,958.32	1	17.25	18.50	10.25	12.50	FAB
16 x 2	A33	* 801-726N	1,449.45	1	14.38	14.75	6.38	12.75	FAB
16 x 3	A33	* 801-728N	1,563.78	1	14.38	14.75	6.38	12.75	FAB
16 x 4	A33	* 801-730N	1,710.83	1	14.38	14.75	6.38	12.75	FAB
16 x 6	A33	* 801-732N	1,820.05	1	15.50	15.75	7.50	12.75	FAB
16 x 8	A33	* 801-734N	2,021.54	1	16.50	16.75	8.50	12.75	FAB
16 x 10	A33	* 801-736N	2,191.37	1	17.50	17.75	9.50	12.75	FAB
16 x 12	A33	* 801-738N	2,414.95	1	18.50	19.75	10.50	13.75	FAB
16 x 14	A33	* 801-740N	2,784.64	1	19.13	20.75	11.13	13.75	FAB
18 x 4	A33	* 801-784N	3,115.59	1	15.63	16.00	6.63	14.00	FAB
18 x 6	A33	* 801-786N	3,374.49	1	16.75	17.00	7.75	14.00	FAB
18 x 8	A33	* 801-788N	3,518.98	1	17.75	18.00	8.75	14.00	FAB
18 x 10	A33	* 801-790N	3,769.91	1	18.75	19.00	9.75	14.00	FAB
18 x 12	A33	* 801-792N	3,984.02	1	19.75	21.00	10.75	15.00	FAB
18 x 14	A33	* 801-794N	4,234.03	1	20.38	22.00	11.38	15.00	FAB
18 x 16	A33	* 801-796N	4,288.13	1	21.38	24.00	12.38	16.00	FAB
20 x 4	A33	* 801-814N	3,821.09	1	16.88	17.25	6.88	15.25	FAB
20 x 6	A33	* 801-816N	4,034.66	1	18.00	18.25	8.00	15.25	FAB
20 x 8	A33	* 801-818N	4,158.67	1	19.00	19.25	9.00	15.25	FAB
20 x 10	A33	* 801-820N	4,330.54	1	20.00	20.25	10.00	15.25	FAB
20 x 12	A33	* 801-822N	4,643.44	1	21.00	22.25	11.00	16.25	FAB
20 x 14	A33	* 801-824N	4,979.46	1	21.63	23.25	11.63	16.25	FAB
20 x 16	A33	* 801-826N	5,337.07	1	22.63	25.25	12.63	17.25	FAB
20 x 18	A33	* 801-828N	5,609.69	1	23.63	27.25	13.63	18.25	FAB
24 x 4	A33	* 801-904N	4,757.75	1	19.38	19.50	7.38	17.50	FAB
24 x 6	A33	* 801-906N	4,939.96	1	20.50	20.50	8.50	17.50	FAB
24 x 8	A33	* 801-908N	5,068.42	1	21.50	21.50	9.50	17.50	FAB
24 x 10	A33	* 801-910N	5,380.33	1	22.50	22.50	10.50	17.50	FAB
24 x 12	A33	* 801-912N	5,578.87	1	23.50	24.50	11.50	18.50	FAB
24 x 14	A33	* 801-914N	5,809.07	1	24.13	25.50	12.13	18.50	FAB
24 x 16	A33	* 801-916N	6,077.06	1	25.13	27.50	13.13	19.50	FAB
24 x 18	A33	* 801-918N	7,350.55	1	26.13	30.50	14.13	20.50	FAB
24 x 20	A33	* 801-920N	7,490.18	1	27.13	32.50	15.13	20.50	FAB
			Call						

**Tee (S x S x FPT)**

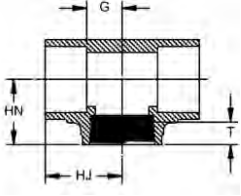

Size (inch)	P/L	Part No.	USD	Pack Qty	HJ (inch)	HN (inch)	G (inch)	T (inch)	Design
1/2	608	802-005	16.34	25	1.41	1.30	0.53	0.81	HS
3/4	608	802-007	21.13	25	1.60	1.37	0.60	0.71	HS
1	608	802-010	24.73	15	1.83	1.73	0.69	0.99	HS
1 1/2	608	802-015	31.06	5	2.41	2.08	1.02	1.04	HS
2	608	802-020	38.31	5	2.79	2.37	1.29	1.08	HS

**Tee (FPT x FPT x FPT)**

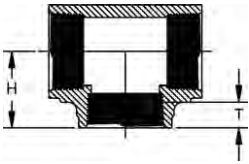

Size (inch)	P/L	Part No.	USD	Pack Qty	H (inch)	T (inch)	Design
1/4	608	^ 805-002	12.62	50	0.94	0.59	HS
3/8	608	^ 805-003	12.62	50	1.01	0.60	HS
1/2	608	^ 805-005	11.94	25	1.26	0.76	HS
3/4	608	^ 805-007	13.28	25	1.36	0.72	HS
1	608	^ 805-010	29.33	15	1.79	0.99	HS
1 1/4	608	^ 805-012	31.09	10	1.93	1.01	HS
1 1/2	608	^ 805-015	37.69	5	2.08	1.03	HS
2	608	^ 805-020	40.52	5	2.39	1.06	HS
2 1/2	608	^ 805-025	147.54	5	2.87	1.35	HS
3	608	^ 805-030	154.08	5	3.52	1.65	HS
4	608	^ 805-040	250.41	5	4.07	1.72	HS

**90° Ell (S x S)**

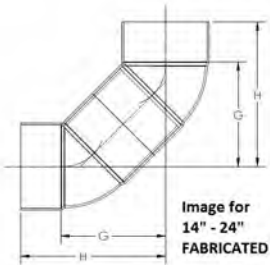
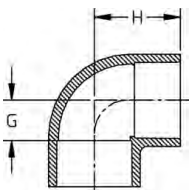

Size (inch)	P/L	Part No.	USD	Pack Qty	H (inch)	G (inch)	Design
1/4	608	* 806-002	3.88	50	0.96	0.35	HS
3/8	608	* 806-003	3.88	50	1.15	0.39	HS
1/2	608	806-005	3.66	25	1.41	0.51	SL
3/4	608	806-007	4.67	25	1.60	0.57	SL
1	608	806-010	7.54	10	1.83	0.68	SL
1 1/4	608	806-012	10.09	10	2.18	0.90	SL
1 1/2	608	806-015	10.81	10	2.43	1.04	SL
2	608	806-020	13.06	20	2.80	1.27	SL
2 1/2	608	806-025	30.57	5	3.33	1.53	SL
3	608	806-030	34.36	5	3.73	1.81	SL
4	608	806-040	52.25	5	4.63	2.32	SL
5	H02	* 806-050S	133.97	1	5.75	3.00	SL
6	608	806-060	148.68	2	6.56	3.53	SL
8	608	806-080	409.82	1	8.68	4.55	SL
10	602	806-100	1,834.08	1	10.79	5.77	SL
12	602	806-120	2,390.86	1	12.92	6.87	SL
14	A33	* 806-140N	1,526.15	1	26.00	19.00	FAB
16	A33	* 806-160N	1,898.04	1	29.00	21.75	FAB
18	A33	* 806-180N	2,712.55	1	33.50	24.50	FAB
20	A33	* 806-200N	3,239.37	1	37.25	27.25	FAB
24	A33	* 806-240N	4,974.45	1	44.75	31.00	FAB

**90° Ell (S x FPT)**

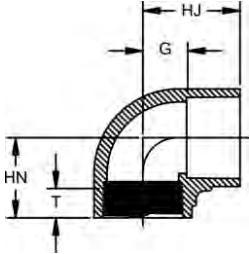

Size (inch)	P/L	Part No.	USD	Pack Qty	HJ (inch)	HN (inch)	G (inch)	T (inch)	Design
½	608	<b>807-005</b>	<b>14.40</b>	25	1.40	1.31	0.50	0.81	HS
¾	608	<b>807-007</b>	<b>16.94</b>	25	1.59	1.36	0.58	0.72	HS
1	608	<b>807-010</b>	<b>18.33</b>	10	1.81	1.70	0.67	1.00	HS
1 ¼	608	<b>807-012</b>	<b>21.13</b>	10	2.15	1.92	0.90	1.03	HS
1 ½	608	<b>807-015</b>	<b>25.21</b>	10	2.39	2.05	1.01	1.05	HS
2	608	<b>807-020</b>	<b>32.65</b>	5	2.77	2.36	1.24	1.09	HS
3	608	<b>807-030</b>	<b>77.99</b>	5	3.73	3.47	1.83	1.66	HS

**90° Ell (FPT x FPT)**

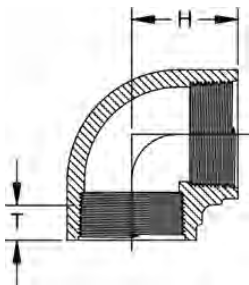

Size (inch)	P/L	Part No.	USD	Pack Qty	H (inch)	T (inch)	Design
¼	608	<b>* 808-002</b>	<b>9.61</b>	50	0.94	0.61	HS
¾	608	<b>* 808-003</b>	<b>9.61</b>	50	1.00	0.63	HS
½	608	<b>^ 808-005</b>	<b>8.47</b>	25	1.27	0.78	HS
¾	608	<b>^ 808-007</b>	<b>10.56</b>	25	1.36	0.72	HS
1	608	<b>^ 808-010</b>	<b>13.28</b>	10	1.71	1.00	HS
1 ¼	608	<b>^ 808-012</b>	<b>14.32</b>	10	1.92	1.01	HS
1 ½	608	<b>^ 808-015</b>	<b>20.29</b>	10	2.08	1.06	HS
2	608	<b>^ 808-020</b>	<b>22.87</b>	5	2.36	1.08	HS
2 ½	608	<b>^ 808-025</b>	<b>89.05</b>	5	3.36	1.51	HS
3	608	<b>^ 808-030</b>	<b>143.60</b>	5	3.53	1.63	HS
4	608	<b>^ 808-040</b>	<b>252.67</b>	5	4.17	1.75	HS

### 45° Ell (S x S)

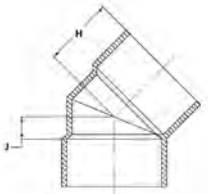
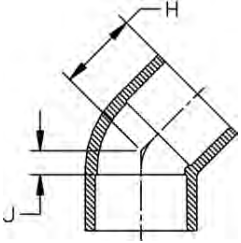
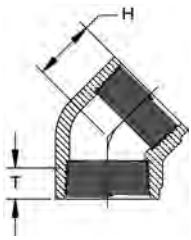

Image for 14"-24"  
Fabricated

Size (inch)	P/L	Part No.	USD	Pack Qty	H (inch)	J (inch)	Design
¼	608	* 817-002	13.88	50	0.81	0.18	HS
⅜	608	* 817-003	13.88	50	0.94	0.19	HS
½	608	817-005	6.89	25	1.22	0.30	SL
¾	608	817-007	10.54	20	1.29	0.28	SL
1	608	817-010	15.79	25	1.48	0.32	SL
1 ¼	608	817-012	20.12	15	1.78	0.47	SL
1 ½	608	817-015	23.78	10	1.88	0.45	SL
2	608	817-020	30.83	5	2.16	0.60	SL
2 ½	608	817-025	64.73	5	2.56	0.79	SL
3	608	817-030	78.79	5	2.67	0.77	SL
4	608	817-040	141.88	5	3.31	1.04	SL
5	H02	* 817-050S	169.75	1	4.00	1.38	SL
6	608	817-060	178.68	2	4.86	1.77	SL
8	608	817-080	387.40	2	6.15	2.07	SL
10	602	817-100	1,219.66	1	7.51	2.46	SL
12	602	817-120	1,573.28	1	9.00	2.96	SL
14	A33	* 817-140N	1,180.36	1	10.25	3.50	FAB
16	A33	* 817-160N	1,445.04	1	11.75	3.75	FAB
18	A33	* 817-180N	1,758.86	1	13.25	4.25	FAB
20	A33	* 817-200N	2,415.88	1	14.75	4.75	FAB
24	A33	* 817-240N	2,992.44	1	17.75	5.75	FAB

### 45° Ell (FPT x FPT)



Size (inch)	P/L	Part No.	USD	Pack Qty	H (inch)	T (inch)	Design
¼	608	* 819-002	15.76	50	0.69	0.59	HS
⅜	608	* 819-003	15.76	50	0.86	0.68	HS
½	608	^ 819-005	13.61	25	1.02	0.76	SL
¾	608	^ 819-007	14.62	20	1.14	0.81	SL
1	608	^ 819-010	18.35	25	1.33	0.97	SL
1 ¼	608	^ 819-012	27.99	15	1.42	1.01	SL
1 ½	608	^ 819-015	35.19	10	1.47	1.07	SL
2	608	^ 819-020	52.17	5	1.74	2.37	SL
3	608	^ 819-030	166.03	5	2.43	1.66	SL
4	608	^ 819-040	238.24	5	2.78	1.76	SL

### Coupling (S x S)

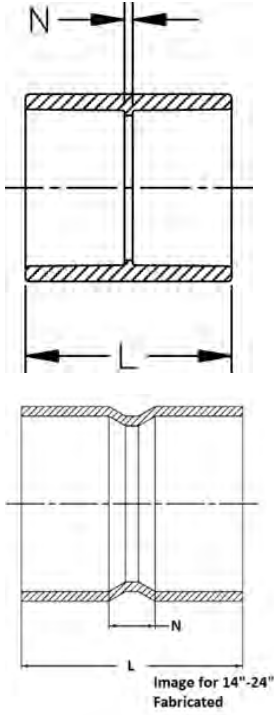

Size (inch)	P/L	Part No.	USD	Pack Qty	L (inch)	N (inch)	Design
¼	H02	* 829-002S	11.20	25	1.38	0.06	SL
⅜	608	* 829-003	11.20	50	1.65	0.11	HS
½	608	829-005	6.62	25	1.93	0.12	SL
¾	608	829-007	8.97	20	2.18	0.12	SL
1	608	829-010	9.22	25	2.41	0.12	SL
1 ¼	608	829-012	14.04	10	2.67	0.13	SL
1 ½	608	829-015	15.14	10	2.94	0.15	SL
2	608	829-020	16.25	20	3.18	0.13	SL
2 ½	608	829-025	40.01	5	3.77	0.19	SL
3	608	829-030	45.94	5	4.04	0.26	SL
4	608	829-040	57.54	5	4.80	0.26	SL
5	H02	* 829-050S	114.11	1	5.47	0.22	SL
6	608	829-060	123.83	2	6.40	0.36	SL
8	608	829-080	168.52	2	8.40	0.35	SL
10	602	829-100	578.40	1	10.77	0.75	SL
12	602	829-120	666.60	1	12.82	0.75	SL
14	A33	* 829-140N	448.99	1	17.75	3.75	FAB
16	A33	* 829-160N	533.80	1	20.25	4.25	FAB
18	A33	* 829-180N	1,052.18	1	22.75	4.75	FAB
20	A33	* 829-200N	1,297.28	1	25.25	5.25	FAB
24	A33	* 829-240N	1,424.43	1	30.25	6.25	FAB

## Reducing Coupling (S x S)

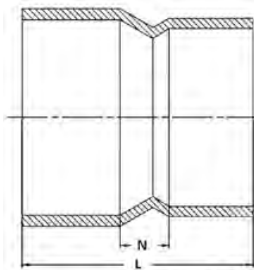
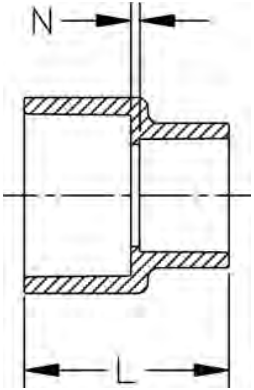

Image for 14"-24"  
Fabricated

Size (inch)	P/L	Part No.	USD	Pack Qty	L (inch)	N (inch)	Design
¾ x ½	608	829-101	8.12	20	2.13	0.13	HS
1 x ½	608	829-130	11.33	25	2.17	0.12	HS
1 x ¾	608	829-131	11.82	25	2.26	0.11	HS
1 ¼ x 1	608	829-168	24.01	10	2.52	0.10	HS
1 ½ x ½	608	* 829-209FB	25.13	10	2.94	0.66	BUSH
1 ½ x ¾	608	829-210	25.13	10	2.50	0.09	BUSH
1 ½ x 1	608	829-211	25.13	10	2.65	0.11	HS
1 ½ x 1 ¼	608	829-212	31.06	10	2.82	0.09	HS
2 x ½	608	* 829-247FB	28.35	5	3.44	0.87	BUSH
2 x ¾	608	829-248	28.35	5	3.14	0.34	HS
2 x 1	608	829-249	28.35	5	3.15	0.32	HS
2 x 1 ¼	608	829-250	28.35	5	3.05	0.14	HS
2 x 1 ½	608	829-251	28.35	5	3.06	0.07	HS
2 ½ x 1 ½	608	829-291	37.81	5	3.36	0.14	HS
2 ½ x 2	608	* 829-292FB	37.81	5	4.08	0.66	BUSH
3 x 1	608	* 829-335FB	82.13	5	4.56	1.53	BUSH
3 x 1 ¼	608	* 829-336FB	86.45	5	4.29	1.07	FAB
3 x 1 ½	608	* 829-337FB	86.45	5	4.58	1.15	BUSH
3 x 2	608	829-338	69.62	5	3.61	0.17	HS
3 x 2 ½	608	* 829-339FB	99.27	5	4.42	0.63	BUSH
4 x 2	608	* 829-420FB	132.72	5	4.94	1.08	BUSH
4 x 3	608	829-422	131.16	5	4.38	0.22	HS
5 x 4	H04	* 829-490FS	67.41	1	7.75	2.50	FAB
6 x 2	608	* 829-528FB	328.40	2	10.61	4.60	BUSH
6 x 4	608	829-532	267.52	2	10.17	3.46	HS
8 x 4	608	* 829-582FB	293.01	2	9.81	3.53	BUSH
8 x 5	H04	* 829-583FS	322.09	1	14.69	7.44	FAB
8 x 6	608	829-585	810.23	2	9.18	2.11	HS
10 x 4	A33	* 829-623N	446.57	1	17.00	10.00	FAB
10 x 6	602	* 829-626FB	948.55	1	11.42	3.29	BUSH
10 x 6	A33	* 829-626N	365.96	1	13.00	5.00	FAB
10 x 8	602	* 829-628FB	948.55	1	11.45	2.32	BUSH
10 x 8	A33	* 829-628N	263.40	1	12.75	3.75	FAB
12 x 4	A33	* 829-663N	623.20	1	26.25	18.25	FAB
12 x 6	A33	* 829-666N	539.09	1	20.50	11.50	FAB
12 x 8	602	* 829-668FB	1,079.36	1	13.54	3.41	BUSH
12 x 8	A33	* 829-668N	417.41	1	15.50	5.50	FAB
12 x 10	602	* 829-670FB	1,093.19	1	13.24	2.13	BUSH
12 x 10	A33	* 829-670N	281.98	1	15.00	4.00	FAB
14 x 4	A33	* 829-696N	908.00	1	21.00	3.00	FAB
14 x 6	A33	* 829-698N	766.96	1	31.00	21.00	FAB
14 x 8	A33	* 829-700N	701.82	1	21.00	10.00	FAB
14 x 10	A33	* 829-702N	686.41	1	17.00	5.00	FAB
14 x 12	A33	* 829-704N	411.72	1	16.50	3.50	FAB
16 x 4	A33	* 829-730N	1,348.14	1	16.50	3.50	FAB
16 x 6	A33	* 829-732N	1,219.28	1	16.50	4.50	FAB
16 x 8	A33	* 829-734N	1,070.86	1	18.05	5.00	FAB
16 x 10	A33	* 829-736N	951.19	1	19.50	6.50	FAB
16 x 12	A33	* 829-738N	801.76	1	19.25	5.25	FAB
16 x 14	A33	* 829-740N	608.63	1	19.50	4.50	FAB
18 x 4	A33	* 829-784N	2,844.55	1	48.50	37.50	FAB
18 x 6	A33	* 829-786N	2,659.00	1	36.00	24.00	FAB
18 x 8	A33	* 829-788N	2,517.64	1	42.50	29.50	FAB
18 x 10	A33	* 829-790N	2,277.47	1	33.50	19.50	FAB
18 x 12	A33	* 829-792N	1,874.64	1	22.00	7.00	FAB
18 x 14	A33	* 829-794N	1,269.06	1	22.25	6.25	FAB
18 x 16	A33	* 829-796N	1,083.43	1	21.75	4.75	FAB
20 x 4	A33	* 829-814N	2,816.13	1	60.50	48.50	FAB
20 x 6	A33	* 829-816N	2,592.86	1	55.50	42.50	FAB
20 x 8	A33	* 829-818N	2,478.28	1	56.25	42.25	FAB
20 x 10	A33	* 829-820N	2,391.36	1	47.25	32.25	FAB

table continued on the next page



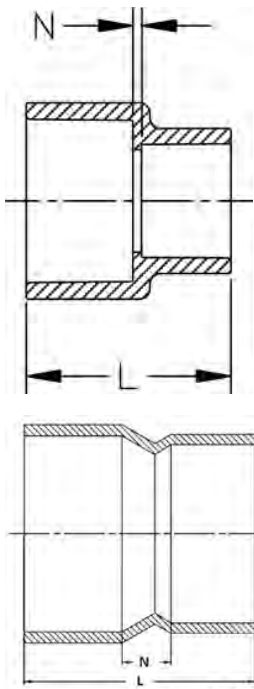
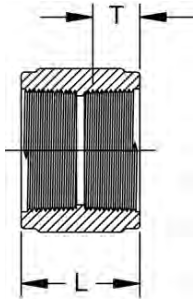

Image for 14"-24"  
Fabricated

Size (inch)	P/L	Part No.	USD	Pack Qty	L (inch)	N (inch)	Design
20 x 12	A33	* 829-822N	2,068.75	1	37.00	21.00	FAB
20 x 14	A33	* 829-824N	2,063.28	1	37.25	20.25	FAB
20 x 16	A33	* 829-826N	1,895.34	1	24.50	6.50	FAB
20 x 18	A33	* 829-828N	1,306.98	1	25.25	6.25	FAB
24 x 4	A33	* 829-904N	4,504.65	1	66.00	52.00	FAB
24 x 6	A33	* 829-906N	4,436.06	1	61.00	46.00	FAB
24 x 8	A33	* 829-908N	4,339.94	1	52.00	36.00	FAB
24 x 10	A33	* 829-910N	4,235.25	1	52.75	35.75	FAB
24 x 12	A33	* 829-912N	3,852.81	1	42.50	24.50	FAB
24 x 14	A33	* 829-914N	3,553.71	1	42.75	23.75	FAB
24 x 16	A33	* 829-916N	3,238.71	1	42.25	22.25	FAB
24 x 18	A33	* 829-918N	2,958.33	1	29.50	8.50	FAB
24 x 20	A33	* 829-920N	2,793.27	1	29.25	7.25	FAB

#### Coupling (FPT x FPT)



Size (inch)	P/L	Part No.	USD	Pack Qty	L (inch)	T (inch)	Design
¼	608	* 830-002	8.46	50	1.29	0.61	HS
⅜	608	* 830-003	8.46	50	1.35	0.62	HS
½	608	^ 830-005	7.41	25	1.68	0.77	SL
¾	608	^ 830-007	10.57	20	1.75	0.80	SL
1	608	^ 830-010	11.35	25	2.13	0.99	SL
1 ¼	608	^ 830-012	14.04	10	2.19	1.03	SL
1 ½	608	^ 830-015	31.24	10	2.22	1.03	SL
2	608	^ 830-020	32.80	5	2.29	1.08	SL
2 ½	608	^ 830-025	78.29	5	3.33	1.51	SL
3	608	^ 830-030	91.81	5	3.53	1.65	SL
4	608	^ 830-040	158.98	5	3.76	1.75	SL

### Reducing Coupling (FPT x FPT)

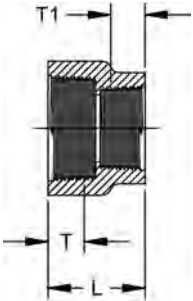

Size (inch)	P/L	Part No.	USD	Pack Qty	L (inch)	T (inch)	T1 (inch)	Design
3/8 x 1/4	608	* 830-052	12.24	50	1.29	0.60	0.59	HS
1/2 x 1/4	608	* 830-072	12.55	50	1.44	0.75	0.59	HS
1/2 x 3/8	608	* 830-073	12.79	50	1.46	0.74	0.60	HS
3/4 x 1/2	608	^ 830-101	8.82	25	1.68	0.78	0.78	HS
1 x 1/2	608	^ 830-130	13.06	25	1.84	0.98	0.77	BUSH
1 x 3/4	608	^ 830-131	13.06	25	1.88	0.98	0.80	HS
1 1/4 x 3/4	608	^ 830-167	28.08	25	1.90	1.00	0.79	HS
1 1/2 x 1	608	^ 830-211	42.99	20	2.06	1.02	0.95	HS
2 x 1 1/2	608	^ 830-251	55.32	10	2.18	1.05	1.02	BUSH

### Female Adapter (S x FPT)

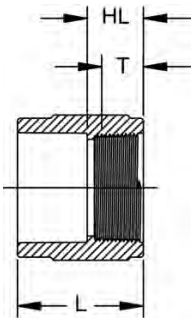

Size (inch)	P/L	Part No.	USD	Pack Qty	HL (inch)	L (inch)	T (inch)	Design
1/4	608	* 835-002	11.92	50	0.75	1.43	0.58	HS
3/8	608	* 835-003	11.92	50	0.75	1.56	0.62	HS
1/2	608	835-005	6.20	25	0.91	1.80	0.75	HS
3/4	608	835-007	9.22	25	0.95	1.96	0.79	HS
1	608	835-010	13.59	25	1.11	2.27	0.98	HS
1 1/4	608	835-012	22.01	10	1.18	2.44	1.02	HS
1 1/2	608	835-015	26.98	10	1.19	2.59	1.03	HS
2	608	835-020	47.07	5	1.25	2.76	1.06	HS
2 1/2	608	835-025	74.32	5	1.77	3.53	1.51	HS
3	608	835-030	83.66	5	1.91	3.80	1.65	HS
4	608	835-040	143.79	5	2.02	4.29	1.74	HS
6	608	835-060	170.26	2	3.27	6.37	2.37	SL
8	608	835-080	320.08	2	4.35	8.36	2.35	HS
10	602	835-100	350.85	2	5.68	10.78	2.68	HS
12	A33	* 835-120N	365.61	1	6.00	11.13	2.13	FAB

### Male Adapter (S x MPT)

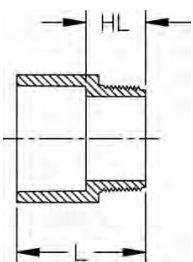

Size (inch)	P/L	Part No.	USD	Pack Qty	HL (inch)	L (inch)	Design
1/2	608	836-005	7.75	50	0.94	1.85	SL
3/4	608	836-007	8.55	25	1.05	2.03	HS
1	608	836-010	14.78	25	1.22	2.38	HS
1 1/4	608	836-012	17.28	15	1.28	2.56	HS
1 1/2	608	836-015	24.83	10	1.30	2.69	HS
2	608	836-020	35.92	5	1.32	2.83	HS
2 1/2	608	836-025	40.82	5	1.87	3.70	HS
3	608	836-030	45.31	5	1.99	3.90	HS
4	608	836-040	80.62	5	2.15	4.40	HS
6	A33	* 836-060N	179.08	1	3.25	6.25	FAB
8	A33	* 836-080N	193.08	1	3.50	7.50	FAB
10	A33	* 836-100N	231.09	1	4.18	9.18	FAB
12	A33	* 836-120N	343.42	1	4.63	10.63	FAB

Flush Style Reducer Bushing (SPG x S)

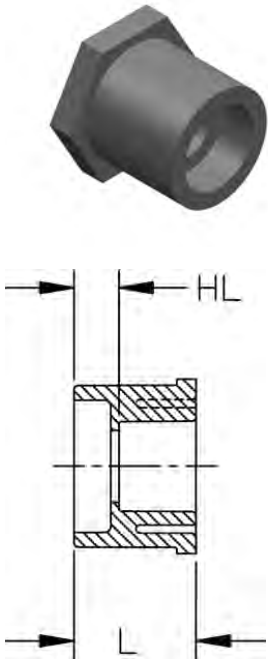

Size (inch)	P/L	Part No.	USD	Pack Qty	HL (inch)	L (inch)	Design
½ x ¼	608	* 837-072	6.23	50	0.47	1.15	FLUSH
½ x ⅜	608	* 837-073	6.23	50	0.33	1.09	FLUSH
¾ x ½	608	837-101	2.14	50	0.42	1.30	FLUSH
1 x ½	608	837-130	6.12	50	0.55	1.44	FLUSH
1 x ¾	608	837-131	6.12	50	0.41	1.43	FLUSH
1 ¼ x ½	608	837-166	9.59	25	0.66	1.55	FLUSH
1 ¼ x ¾	608	837-167	9.59	25	0.56	1.57	FLUSH
1 ¼ x 1	608	837-168	9.59	25	0.44	1.59	FLUSH
1 ½ x ½	608	837-209	13.06	25	0.78	1.69	FLUSH
1 ½ x ¾	608	837-210	13.06	25	0.67	1.68	FLUSH
1 ½ x 1	608	837-211	13.06	25	0.55	1.69	FLUSH
1 ½ x 1 ¼	608	837-212	13.06	25	0.44	1.72	FLUSH
2 x ½	608	837-247	18.62	10	0.91	1.81	FLUSH
2 x ¾	608	837-248	18.62	10	0.79	1.82	FLUSH
2 x 1	608	837-249	18.62	10	0.68	1.83	FLUSH
2 x 1 ¼	608	837-250	18.62	10	0.54	1.81	FLUSH
2 x 1 ½	608	837-251	18.62	10	0.40	1.81	FLUSH
2 ½ x 1 ½	608	837-291	32.35	5	0.79	2.31	FLUSH
2 ½ x 2	608	837-292	32.35	5	0.47	2.10	FLUSH
3 x 1	608	837-335	51.32	5	1.27	2.42	FLUSH
3 x 1 ¼	608	* 837-336FB	51.32	5	1.43	2.71	FLUSH
3 x 1 ½	608	837-337	51.32	5	0.89	2.43	FLUSH
3 x 2	608	837-338	51.32	5	0.86	2.42	FLUSH
3 x 2 ½	608	837-339	51.32	5	0.38	2.27	FLUSH
4 x 2	608	837-420	71.04	5	1.14	2.70	FLUSH
4 x 3	608	837-422	71.04	5	0.77	2.74	FLUSH
6 x 3	608	837-530	98.79	2	1.74	3.65	FLUSH
6 x 4	608	837-532	98.79	2	1.42	3.67	FLUSH
6 x 5	H02	* 837-534S	98.79	1	0.88	3.53	FLUSH
8 x 6	608	837-585	240.33	2	1.69	4.66	FLUSH
10 x 4	602	* 837-623FB	669.11	1	4.01	6.26	BUSH
10 x 6	602	837-626	564.56	1	2.59	5.69	FLUSH
10 x 8	602	837-628	564.56	1	1.62	5.72	FLUSH
12 x 6	602	* 837-666FB	910.98	1	4.26	7.35	BUSH
12 x 8	602	837-668	652.43	1	2.66	6.76	FLUSH
12 x 10	602	837-670	652.43	1	1.66	6.77	FLUSH
14 x 4	A33	* 837-696N	1,413.94	1	5.50	7.50	FAB
14 x 6	A33	* 837-698N	1,258.96	1	4.50	7.50	FAB
14 x 8	A33	* 837-700N	902.03	1	3.50	7.50	FAB
14 x 10	A33	* 837-702N	563.13	1	2.50	7.50	FAB
14 x 12	A33	* 837-704N	241.57	1	1.50	7.50	FAB
16 x 4	A33	* 837-730N	1,615.28	1	6.50	8.50	FAB
16 x 6	A33	* 837-732N	1,499.93	1	5.50	8.50	FAB
16 x 8	A33	* 837-734N	1,180.92	1	4.50	8.50	FAB
16 x 10	A33	* 837-736N	855.97	1	3.50	8.50	FAB
16 x 12	A33	* 837-738N	505.19	1	2.50	8.50	FAB
16 x 14	A33	* 837-740N	493.51	1	1.50	8.50	FAB
18 x 4	A33	* 837-784N	2,775.37	1	7.50	9.50	FAB
18 x 6	A33	* 837-786N	2,542.81	1	6.50	9.50	FAB
18 x 8	A33	* 837-788N	2,329.75	1	5.50	9.50	FAB
18 x 10	A33	* 837-790N	1,912.45	1	4.50	9.50	FAB
18 x 12	A33	* 837-792N	1,218.69	1	3.50	9.50	FAB
18 x 14	A33	* 837-794N	1,207.09	1	2.50	9.50	FAB
18 x 16	A33	* 837-796N	557.49	1	1.50	9.50	FAB
20 x 4	A33	* 837-814N	3,835.67	1	8.50	10.50	FAB
20 x 6	A33	* 837-816N	3,547.44	1	7.50	10.50	FAB
20 x 8	A33	* 837-818N	3,280.87	1	6.50	10.50	FAB
20 x 10	A33	* 837-820N	3,037.15	1	5.50	10.50	FAB
20 x 12	A33	* 837-822N	2,693.03	1	4.50	10.50	FAB
20 x 14	A33	* 837-824N	2,214.35	1	3.50	10.50	FAB
20 x 16	A33	* 837-826N	1,737.44	1	2.50	10.50	FAB

table continued on the next page

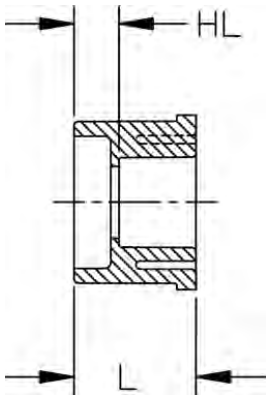

Size (inch)	P/L	Part No.	USD	Pack Qty	HL (inch)	L (inch)	Design
20 x 18	A33	* 837-828N	906.99	1	1.50	10.50	FAB
24 x 4	A33	* 837-904N	5,747.80	1	10.50	12.50	FAB
24 x 6	A33	* 837-906N	5,572.80	1	9.50	12.50	FAB
24 x 8	A33	* 837-908N	5,403.13	1	8.50	12.50	FAB
24 x 10	A33	* 837-910N	4,746.07	1	7.50	12.50	FAB
24 x 12	A33	* 837-912N	4,282.03	1	6.50	12.50	FAB
24 x 14	A33	* 837-914N	4,010.47	1	5.50	12.50	FAB
24 x 16	A33	* 837-916N	3,793.66	1	4.50	12.50	FAB
24 x 18	A33	* 837-918N	3,288.27	1	3.50	12.50	FAB
24 x 20	A33	* 837-920N	2,717.57	1	2.50	12.50	FAB

### Flush Style Reducer Bushing (SPG x FPT)

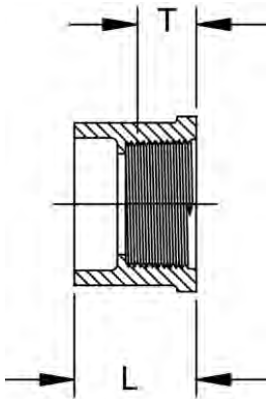

Size (inch)	P/L	Part No.	USD	Pack Qty	L (inch)	T (inch)	Design
3/8 x 1/4	608	* 838-052E	6.23	50	1.59	0.60	Extended
1/2 x 1/4	608	* 838-072	6.23	50	1.14	0.61	FLUSH
1/2 x 3/8	608	* 838-073	6.23	50	1.21	0.60	FLUSH
3/4 x 1/4	608	* 838-098	3.86	50	1.13	0.61	FLUSH
3/4 x 1/2	608	838-101	3.86	50	1.28	0.77	FLUSH
1 x 1/2	608	838-130	6.12	50	1.42	0.76	FLUSH
1 x 3/4	608	838-131	6.12	50	1.41	0.81	FLUSH
1 1/4 x 1/2	608	838-166	12.42	15	1.56	0.75	FLUSH
1 1/4 x 3/4	608	838-167	12.42	15	1.56	0.79	FLUSH
1 1/4 x 1	608	838-168	12.42	15	1.56	0.99	FLUSH
1 1/2 x 1/2	608	838-209	15.56	15	1.68	0.76	FLUSH
1 1/2 x 3/4	608	838-210	15.56	15	1.69	0.79	FLUSH
1 1/2 x 1	608	838-211	15.56	15	1.68	0.99	FLUSH
1 1/2 x 1 1/4	608	838-212	15.56	15	1.69	1.10	FLUSH
2 x 1/2	608	838-247	19.03	10	1.80	0.77	FLUSH
2 x 3/4	608	838-248	19.03	10	1.80	0.80	FLUSH
2 x 1	608	838-249	19.03	10	1.80	0.99	FLUSH
2 x 1 1/4	608	838-250	19.03	10	1.81	1.02	FLUSH
2 x 1 1/2	608	838-251	19.03	10	1.88	1.04	FLUSH
2 1/2 x 1 1/2	608	838-291	40.29	5	2.24	1.07	FLUSH
2 1/2 x 2	608	838-292	40.29	5	2.12	1.10	FLUSH
3 x 2	608	838-338	74.60	5	2.42	1.07	FLUSH
3 x 2 1/2	608	838-339	74.60	5	2.25	1.61	FLUSH
4 x 2	608	838-420	114.60	5	2.71	1.10	FLUSH
4 x 3	608	838-422	114.60	5	2.75	1.62	FLUSH

### Flush Style Reducer Bushing (MPT x FPT)

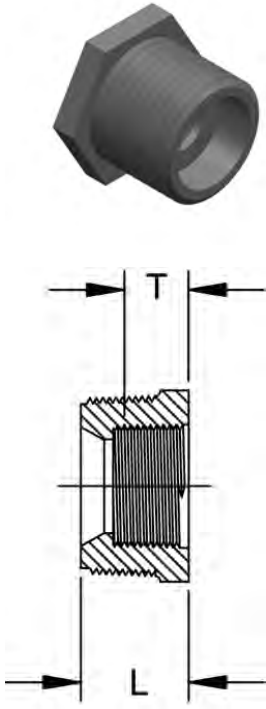

Size (inch)	P/L	Part No.	USD	Pack Qty	L (inch)	T (inch)	Style
3/8 x 1/4	608	* 839-052	14.41	50	0.80	0.60	FLUSH
1/2 x 1/4	608	* 839-072	14.41	50	0.95	0.60	FLUSH
1/2 x 3/8	608	* 839-073	14.41	50	0.96	0.61	FLUSH
3/4 x 1/4	608	* 839-098	9.95	50	1.01	0.61	FLUSH
3/4 x 3/8	608	* 839-099	9.95	50	1.02	0.61	FLUSH
3/4 x 1/2	608	^ 839-101	8.20	50	1.08	0.75	FLUSH
1 x 1/4	608	* 839-128	16.05	25	1.23	0.58	FLUSH
1 x 1/2	608	^ 839-130	12.84	25	1.24	0.76	FLUSH
1 x 3/4	608	^ 839-131	12.84	25	1.28	0.80	FLUSH
1 1/4 x 1/2	608	^ 839-166	13.62	25	1.29	0.76	FLUSH
1 1/4 x 3/4	608	^ 839-167	13.62	25	1.29	0.79	FLUSH
1 1/4 x 1	608	^ 839-168	13.62	25	1.30	1.00	FLUSH
1 1/2 x 3/4	608	^ 839-210	16.15	25	1.33	0.78	FLUSH
1 1/2 x 1	608	^ 839-211	16.15	25	1.34	0.98	FLUSH
1 1/2 x 1 1/4	608	^ 839-212	16.15	25	1.33	1.02	FLUSH
2 x 1/2	608	^ 839-247	23.65	10	1.44	0.76	FLUSH
2 x 3/4	608	^ 839-248	23.65	10	1.44	0.80	FLUSH
2 x 1	608	^ 839-249	23.65	10	1.42	0.97	FLUSH
2 x 1 1/4	608	^ 839-250	23.65	10	1.43	1.01	FLUSH
2 x 1 1/2	608	^ 839-251	23.65	10	1.35	1.02	FLUSH
3 x 2	608	^ 839-338	43.54	5	2.02	1.09	FLUSH
4 x 2	608	^ 839-420	89.74	5	2.07	1.10	FLUSH
4 x 3	608	^ 839-422	114.60	5	2.06	1.60	FLUSH

### Cap (S)

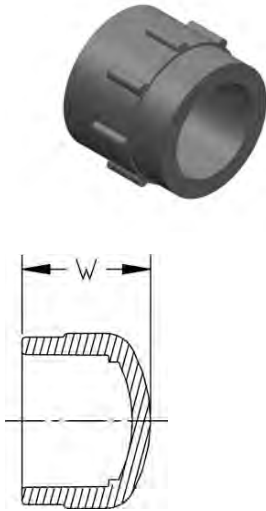

Size (inch)	P/L	Part No.	USD	Pack Qty	W (inch)	Design
1/4	608	* 847-002	8.88	50	0.96	HS
3/8	608	* 847-003	8.88	50	1.11	HS
1/2	608	847-005	6.48	50	1.30	HS
3/4	608	847-007	6.83	50	1.46	HS
1	608	847-010	12.15	25	1.66	HS
1 1/4	608	847-012	14.65	15	1.89	HS
1 1/2	608	847-015	14.65	10	2.08	HS
2	608	847-020	28.93	5	2.32	HS
2 1/2	608	847-025	59.07	5	2.61	HS
3	608	847-030	69.12	5	3.06	HS
4	608	847-040	116.56	5	3.69	HS
5	H04	* 847-050FS	148.02	1	4.44	FAB
6	608	847-060	289.95	2	4.86	HS
8	608	847-080	372.27	2	6.25	SL
10	602	847-100	380.81	1	7.92	SL
12	602	847-120	571.52	1	9.37	SL
14	A33	* 847-140N	632.92	1	5.75	FAB
16	A33	* 847-160N	819.95	1	7.00	FAB
18	A33	* 847-180N	1,197.09	1	8.25	FAB
20	A33	* 847-200N	1,604.76	1	8.75	FAB
24	A33	* 847-240N	2,985.54	1	10.25	FAB

### Cap (FPT)

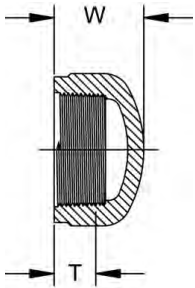

Size (inch)	P/L	Part No.	USD	Pack Qty	W (inch)	T (inch)	Design
¼	608	* 848-002	8.57	50	0.93	0.54	HS
¾	608	* 848-003	8.57	50	0.94	0.62	HS
½	608	^ 848-005	8.12	50	1.14	0.74	HS
¾	608	^ 848-007	9.08	25	1.25	0.80	HS
1	608	^ 848-010	11.44	25	1.51	0.97	HS
1 ¼	608	^ 848-012	13.62	15	1.59	1.00	HS
1 ½	608	^ 848-015	15.56	10	1.70	1.01	HS
2	608	^ 848-020	30.57	5	1.82	1.06	HS
2 ½	608	^ 848-025	61.15	5	2.61	1.45	HS
3	608	^ 848-030	71.99	5	2.80	1.83	HS
4	608	^ 848-040	126.76	5	3.16	1.80	HS

### Plug (SPG)

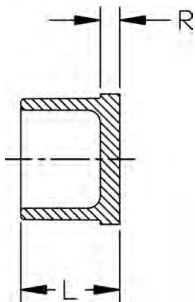

Size (inch)	P/L	Part No.	USD	Pack Qty	L (inch)	R (inch)
½	608	849-005	6.06	50	1.08	0.18
¾	608	849-007	6.75	50	1.25	0.22
1	608	849-010	7.61	25	1.41	0.25
1 ½	608	849-015	10.66	20	1.72	0.31
2	608	849-020	14.11	10	1.90	0.38
4	608	849-040	87.11	5	2.65	0.39

### Plug (MPT)

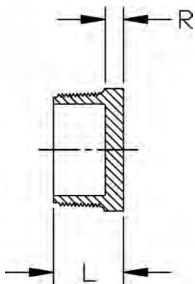

Size (inch)	P/L	Part No.	USD	Pack Qty	L (inch)	R (inch)	Design
¼	608	* 850-002	7.40	50	0.81	0.22	HS
¾	608	* 850-003	7.40	50	0.83	0.22	HS
½	608	850-005	6.24	50	0.98	0.22	HS
¾	608	850-007	6.48	50	1.06	0.25	HS
1	608	850-010	7.95	25	1.24	0.27	HS
1 ¼	608	850-012	11.72	25	1.33	0.31	HS
1 ½	608	850-015	14.24	20	1.38	0.34	HS
2	608	850-020	14.62	10	1.47	0.39	HS
2 ½	608	850-025	40.82	10	1.95	0.38	HS
3	608	850-030	47.63	5	1.98	0.38	HS
4	608	850-040	92.73	5	2.16	0.39	HS
6	A33	* 850-060N	110.24	1	2.00	0.75	FAB
8	A33	* 850-080N	426.96	1	2.00	0.75	FAB
10	A33	* 850-100N	521.92	1	2.00	0.75	FAB
12	A33	* 850-120N	588.27	1	2.00	0.75	FAB



### Flange - One Piece (S)

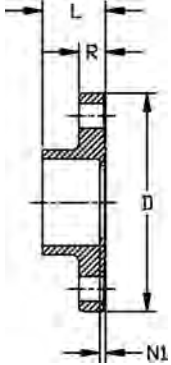

- ANSI 150 Class according to ANSI B16.5
- 150 psi @ 73°F (10.3 bar @ 22.7°C)
- HC = Honeycomb (Face)

Size (inch)	P/L	Part No.	USD
½	608	<b>851-005</b>	<b>20.06</b>
¾	608	<b>851-007</b>	<b>21.44</b>
1	608	<b>851-010</b>	<b>23.87</b>
1 ¼	608	<b>851-012</b>	<b>24.60</b>
1 ½	608	<b>851-015</b>	<b>25.13</b>
2	608	<b>851-020</b>	<b>33.45</b>
2 ½	608	<b>851-025</b>	<b>51.63</b>
3	608	<b>851-030</b>	<b>57.02</b>
4	608	<b>851-040</b>	<b>72.20</b>
5	H02	<b>* 851-050S</b>	<b>Call</b>
6	608	<b>851-060</b>	<b>113.52</b>
8	608	<b>851-080</b>	<b>203.14</b>

Pack Qty	# holes	Bolt Dia. (inch)	bolt cir. dia. (inch)	D (inch)	L (inch)	N1 (inch)	R (inch)	Design
5	4	½	2.38	3.50	1.02	0.13	0.39	HC
5	4	½	2.75	3.89	1.14	0.13	0.45	HC
5	4	½	3.13	4.28	1.30	0.16	0.52	HC
5	4	½	3.50	4.64	1.45	0.14	0.59	HC
5	4	½	3.88	5.01	1.54	0.16	0.68	HC
5	4	⅝	4.75	6.01	1.73	0.16	0.69	HC
5	4	⅝	5.50	7.00	1.99	0.17	0.75	HC
5	4	⅝	6.00	7.51	2.46	0.57	1.10	HC
5	8	⅝	7.50	9.04	2.79	0.52	1.19	HC
5	8	¾	8.50	10.13	3.25	0.25	1.00	HC
2	8	¾	9.50	11.13	3.88	0.36	1.38	HC
2	8	¾	11.75	13.54	4.90	0.42	1.45	HC

### Flange - One Piece (FPT)

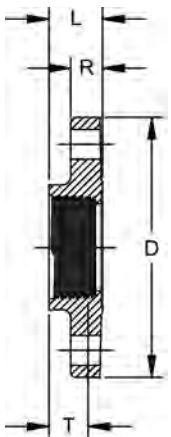

- ANSI 150 Class according to ANSI B16.5
- 75 psi @ 73°F (5.2 bar @ 22.7°C)
- HC = Honeycomb (Face)

Size (inch)	P/L	Part No.	USD
½	608	<b>^ 852-005</b>	<b>24.01</b>
¾	608	<b>^ 852-007</b>	<b>28.14</b>
1	608	<b>^ 852-010</b>	<b>30.80</b>
1 ¼	608	<b>^ 852-012</b>	<b>42.47</b>
1 ½	608	<b>^ 852-015</b>	<b>46.35</b>
2	608	<b>^ 852-020</b>	<b>47.40</b>
2 ½	608	<b>^ 852-025</b>	<b>108.99</b>
3	608	<b>^ 852-030</b>	<b>112.18</b>
4	608	<b>^ 852-040</b>	<b>210.77</b>

Pack Qty	# holes	Bolt Dia. (inch)	bolt cir. dia. (inch)	D (inch)	L (inch)	T (inch)	R (inch)	Design
5	4	½	2.38	3.51	0.89	0.77	0.39	HC
5	4	½	2.75	3.89	0.91	0.79	0.45	HC
5	4	½	3.13	4.28	1.13	1.00	0.53	HC
5	4	½	3.50	4.62	1.20	1.06	0.58	HC
5	4	½	3.88	4.99	1.19	1.03	0.68	HC

table continued on the next page

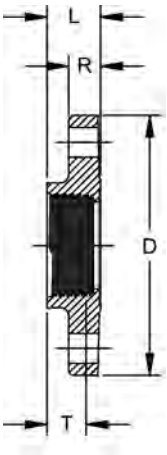

Pack Qty	# holes	Bolt Dia. (inch)	bolt cir. dia. (inch)	D (inch)	L (inch)	T (inch)	R (inch)	Design
5	4	5/8	4.75	6.02	1.22	1.06	0.70	HC
5	4	5/8	5.50	7.00	1.72	1.53	0.75	HC
5	4	5/8	6.00	7.50	2.15	1.63	1.15	HC
5	8	5/8	7.50	9.00	2.30	1.77	1.23	HC

## Flange - Van Stone (S)

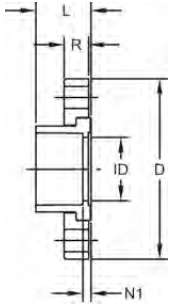

- ANSI 150 Class according to ANSI B16.5
- 1/2" - 12" pressure rating is 150 psi @ 73°F (10.3 bar @ 22.7°C)
- 14" - 24" pressure rating is 100 psi @ 73°F (6.9 bar @ 22.7°C) - Steel Ring
- HC = Honeycomb (Face)

Size (inch)	P/L	Part No.	USD
1/2	608	854-005	20.03
3/4	608	854-007	21.43
1	608	854-010	23.86
1 1/4	608	854-012	24.58
1 1/2	608	854-015	25.07
2	608	854-020	33.40
2 1/2	608	854-025	51.58
3	608	854-030	57.00
4	608	854-040	72.09
5	H02	* 854-050S	113.42
6	608	854-060	113.42
8	608	854-080	206.85
10	602	854-100	294.51
12	602	854-120	435.08
14	A33	* 854-140N	1,358.94
16	A33	* 854-160N	1,646.04
18	A33	* 854-180N	2,005.42
20	A33	* 854-200N	2,430.13
24	A33	* 854-240N	3,270.57

Size (inch)	Pack Qty	# holes	Bolt Dia. (inch)	bolt cir. dia. (inch)	D (inch)	L (inch)	N1 (inch)	R (inch)	ID (inch)	Design
1/2	5	4	1/2	2.38	3.53	1.10	0.18	0.57	0.60	HC
3/4	5	4	1/2	2.75	3.87	1.23	0.18	0.59	0.82	HC
1	5	4	1/2	3.13	4.25	1.38	0.20	0.66	1.03	HC
1 1/4	5	4	1/2	3.50	4.62	1.52	0.21	0.69	1.36	HC
1 1/2	5	4	1/2	3.88	5.01	1.68	0.25	0.75	1.60	HC
2	5	4	5/8	4.75	6.02	1.84	0.29	0.82	2.06	HC
2 1/2	5	4	5/8	5.50	7.01	2.15	0.33	0.98	2.49	HC
3	5	4	5/8	6.00	7.50	2.33	0.39	1.02	3.09	HC
4	5	8	5/8	7.50	8.99	2.75	0.24	1.10	4.06	HC
5	1	8	3/4	8.50	10.18	2.98	0.33	1.13	4.81	HC
6	2	8	3/4	9.50	10.98	3.55	0.48	1.25	6.11	HC
8	2	8	3/4	11.75	13.51	4.60	0.51	1.71	8.00	HC
10	2	12	7/8	14.25	15.97	5.66	0.53	1.73	10.10	HC
12	2	12	7/8	17.00	18.95	6.71	0.57	1.72	11.96	HC
14	1	12	1	18.75	21.00	11.75	4.75	0.50	12.50	FAB
16	1	16	1	21.25	23.50	13.50	5.50	0.50	14.31	FAB
18	1	16	1 1/8	22.75	25.00	14.50	5.50	0.50	16.13	FAB
20	1	20	1 1/8	25.00	27.50	17.25	7.25	0.50	18.00	FAB
24	1	20	1 1/4	29.50	32.00	19.50	7.50	0.50	21.56	FAB

### Flange - Van Stone (FPT)

- ANSI 150 Class according to ANSI B16.5
- 75 psi @ 73°F (5.2 bar @ 22.7°C)
- HC = Honeycomb (Face)

Size (inch)	P/L	Part No.	USD
½	608	^ 855-005	23.97
¾	608	^ 855-007	28.13
1	608	^ 855-010	30.76
1 ¼	608	^ 855-012	42.39
1 ½	608	^ 855-015	46.31
2	608	^ 855-020	47.38
2 ½	608	^ 855-025	108.91
3	608	^ 855-030	112.03
4	608	^ 855-040	203.69

Size (inch)	Pack Qty	# holes	Bolt Dia. (inch)	bolt cir. dia. (inch)	D (inch)	L (inch)	T (inch)	R (inch)	ID (inch)	Design
½	5	4	½	2.38	3.53	1.10	0.79	0.57	0.63	HC
¾	5	4	½	2.75	3.87	1.23	0.82	0.59	0.83	HC
1	5	4	½	3.13	4.25	1.39	1.01	0.66	1.06	HC
1 ¼	5	4	½	3.50	4.62	1.50	1.02	0.69	1.38	HC
1 ½	5	4	½	3.88	5.01	1.67	1.06	0.75	1.61	HC
2	5	4	⅝	4.75	6.02	1.82	1.09	0.82	2.08	HC
2 ½	5	4	⅝	5.50	7.01	2.13	1.58	0.98	2.50	HC
3	5	4	⅝	6.00	7.50	2.36	1.71	1.02	3.08	HC
4	5	8	⅝	7.50	8.99	2.78	1.72	1.10	4.09	HC

### Flange - Van Stone (SPG)

- ANSI 150 Class according to ANSI B16.5
- 1/2" - 12" pressure rating is 150 psi @ 73°F (10.3 bar @ 22.7°C)
- 14" - 24" pressure rating is 100 psi @ 73°F (6.9 bar @ 22.7°C) - Steel Ring
- HC = Honeycomb (Face)

Size (inch)	P/L	Part No.	USD
½	608	856-005	20.15
¾	608	856-007	21.59
1	608	856-010	24.06
1 ¼	608	856-012	24.82
1 ½	608	856-015	25.32
2	608	856-020	33.65
2 ½	608	856-025	52.01
3	608	856-030	57.45
4	608	856-040	72.69
6	608	856-060	114.35
8	608	856-080	204.56
10	602	856-100	239.11
12	602	856-120	257.80
14	A33	* 856-140N	1,080.58
16	A33	* 856-160N	1,320.79
18	A33	* 856-180N	1,496.59
20	A33	* 856-200N	1,802.62
24	A33	* 856-240N	2,447.77

table continued on the next page

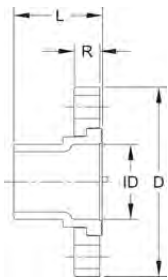

Pack Qty	# holes	Bolt Dia. (inch)	bolt cir. dia. (inch)	D (inch)	L (inch)	R (inch)	ID (inch)	Design
5	4	½	2.38	3.53	1.72	0.57	0.84	HC
5	4	½	2.75	3.87	1.85	0.59	1.05	HC
5	4	½	3.13	4.25	2.10	0.66	1.32	HC
5	4	½	3.50	4.62	2.28	0.69	1.66	HC
5	4	½	3.88	5.01	2.48	0.75	1.90	HC
5	4	⅝	4.75	6.02	2.80	0.82	2.38	HC
5	4	⅝	5.50	7.01	3.27	0.98	2.86	HC
5	4	⅝	6.00	7.50	3.60	1.02	3.49	HC
5	8	⅝	7.50	8.99	4.10	1.10	4.49	HC
2	8	¾	9.50	10.98	5.10	1.25	6.60	HC
1	8	¾	11.75	13.51	6.88	1.71	8.62	HC
1	12	⅞	14.25	15.97	8.30	1.73	10.70	HC
1	12	⅞	17.00	18.95	9.55	1.72	12.69	HC
1	12	1	18.75	21.00	13.00	0.50	11.41	FAB
1	16	1	21.25	23.50	14.00	0.50	13.08	FAB
1	16	1 ⅛	22.75	25.00	16.00	0.50	14.76	FAB
1	20	1 ⅛	25.00	27.50	18.00	0.50	16.43	FAB
1	20	1 ¼	29.50	32.00	20.00	0.50	19.79	FAB

### Flange (Blind)



- ANSI 150 Class according to ANSI B16.5
- 1/2" - 8" 150 psi @ 73°F (10.3 bar @ 22.7°C)
- 10" - 24" 50 psi @ 73°F (3.5 bar @ 22.7°C)
- HC = Honeycomb (Face)

Size (inch)	P/L	Part No.	USD
½	608	<b>853-005</b>	<b>28.13</b>
¾	608	<b>853-007</b>	<b>33.49</b>
1	608	<b>853-010</b>	<b>45.75</b>
1 ¼	608	<b>853-012</b>	<b>56.16</b>
1 ½	608	<b>853-015</b>	<b>56.16</b>
2	608	<b>853-020</b>	<b>83.92</b>
2 ½	608	<b>853-025</b>	<b>136.71</b>
3	608	<b>853-030</b>	<b>164.98</b>
4	608	<b>853-040</b>	<b>205.52</b>
5	H04	<b>* 853-050FS</b>	<b>515.18</b>
6	608	<b>853-060</b>	<b>249.75</b>
8	608	<b>853-080</b>	<b>312.61</b>
10	A33	<b>* 853-100N</b>	<b>522.74</b>
12	A33	<b>* 853-120N</b>	<b>814.13</b>
14	A33	<b>* 853-140N</b>	<b>1,548.80</b>
16	A33	<b>* 853-160N</b>	<b>1,836.58</b>
18	A33	<b>* 853-180N</b>	<b>2,065.47</b>
20	A33	<b>* 853-200N</b>	<b>3,338.52</b>
24	A33	<b>* 853-240N</b>	<b>4,450.94</b>

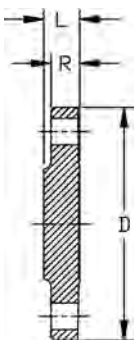

Pack Qty	# holes	Bolt Dia. (inch)	bolt cir. dia. (inch)	D (inch)	L (inch)	R (inch)	Design
5	4	½	2.38	3.51	0.48	0.39	HC
5	4	½	2.75	3.90	0.55	0.45	HC
5	4	½	3.13	4.29	0.66	0.53	HC
5	4	½	3.50	4.62	0.73	0.59	HC
5	4	½	3.88	5.01	0.81	0.68	HC
5	4	⅝	4.75	6.02	0.90	0.70	HC
5	4	⅝	5.50	7.00	0.97	0.76	HC
5	4	⅝	6.00	7.45	1.03	1.03	HC
5	8	⅝	7.50	8.96	1.14	1.14	HC
1	8	1 ⅛	8.50	10.06	1.00	1.00	SOLID

table continued on the next page

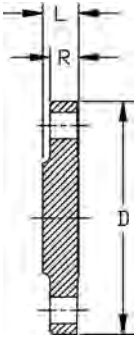

Pack Qty	# holes	Bolt Dia. (inch)	bolt cir. dia. (inch)	D (inch)	L (inch)	R (inch)	Design
2	8	3/4	9.50	10.95	1.51	1.27	HC
2	8	3/4	11.75	13.51	1.62	1.45	HC
1	12	7/8	14.25	16.00	1.00	1.00	SOLID
1	12	7/8	17.00	19.00	1.00	1.00	SOLID
1	12	1	18.75	21.00	1.00	1.00	SOLID
1	16	1	21.25	23.50	1.00	1.00	SOLID
1	16	1 1/8	22.75	25.00	1.00	1.00	SOLID
1	20	1 1/8	25.00	27.50	1.00	1.00	SOLID
1	20	1 1/4	29.50	32.00	1.00	1.00	SOLID



### Flange - Van Stone 300 (S)

- ANSI 300 Class according to ANSI B16.5
- 150 psi @ 73°F (10.3 bar @ 22.7°C)

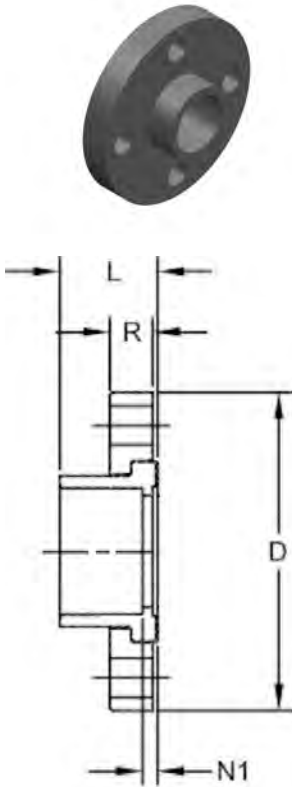

Size (inch)	P/L	Part No.	USD
½	608	* 854-005-300	156.66
¾	608	* 854-007-300	181.80
1	608	* 854-010-300	285.65
1 ¼	608	* 854-012-300	291.67
1 ½	608	* 854-015-300	302.98
2	608	* 854-020-300	319.00
2 ½	608	* 854-025-300	350.27
3	608	* 854-030-300	384.68
4	608	* 854-040-300	652.28
6	608	* 854-060-300	1,242.36
8	608	* 854-080-300	1,414.14
10	602	* 854-100-300	1,664.84
12	602	* 854-120-300	2,133.00

Size	Pack Qty	# holes	Bolt Dia. (inch)	bolt cir. dia. (inch)	D (inch)	L (inch)	N1 (inch)	R (inch)	Design
½	5	4	½	2.63	3.75	1.03	0.11	0.57	FAB
¾	5	4	⅝	3.25	4.63	1.15	0.13	0.59	FAB
1	5	4	⅝	3.50	4.88	1.38	0.11	0.66	FAB
1 ¼	5	4	⅝	3.88	5.25	1.45	0.14	0.69	FAB
1 ½	5	4	¾	4.50	6.13	1.59	0.15	0.75	FAB
2	5	8	⅝	5.00	6.50	1.76	0.20	0.82	FAB
2 ½	5	8	¾	5.88	7.50	2.05	0.22	0.98	FAB
3	5	8	¾	6.63	8.25	2.25	0.30	1.02	FAB
4	5	8	¾	7.88	10.00	2.65	0.34	1.10	FAB
6	2	12	¾	10.63	12.50	3.45	0.35	1.25	FAB
8	2	12	⅞	13.00	15.00	4.50	0.40	1.71	FAB
10	2	16	1	15.25	17.50	5.63	0.50	1.73	FAB
12	2	16	1 ⅛	17.75	20.50	6.69	0.56	1.72	FAB

### Union Type 375 (S x S)

235 psi @ 73°F (16.2 bar @ 22.7°C)

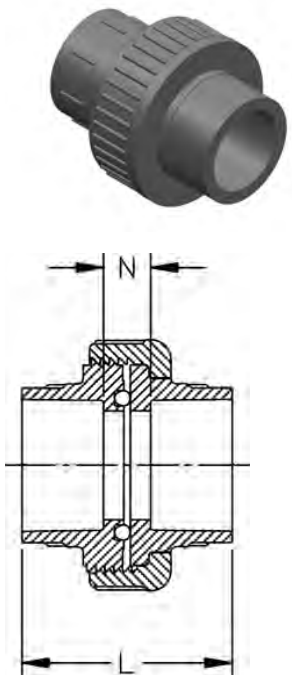

Size (inch)	P/L	EPDM Part No.	USD	FKM Part No.	USD	Pack Qty	L (inch)	N (inch)
½	608	897-375-005	13.39	857-375-005	13.59	25	2.56	0.78
¾	608	897-375-007	17.04	857-375-007	17.26	10	2.80	0.76
1	608	897-375-010	19.51	857-375-010	19.69	5	3.22	0.89
1 ¼	608	897-375-012	38.66	857-375-012	39.13	5	3.56	0.99
1 ½	608	897-375-015	43.75	857-375-015	44.31	5	3.76	0.92
2	608	897-375-020	59.36	857-375-020	60.06	2	4.18	1.11

### Union Type 375 (FPT X FPT)

- 117 psi @ 73°F (8.1 bar @ 22.7°C)

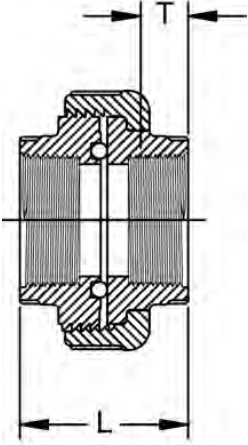

Size (inch)	P/L	EPDM Part No.	USD	FKM Part No.	USD	Pack Qty	L (inch)	T (inch)
½	608	* 898-375-005	15.75	* 858-375-005	15.56	25	2.06	0.75
¾	608	* 898-375-007	22.06	* 858-375-007	21.76	10	2.11	0.79
1	608	* 898-375-010	29.34	* 858-375-010	28.99	5	2.60	1.01
1 ¼	608	* 898-375-012	55.99	* 858-375-012	55.28	5	2.80	1.06
1 ½	608	* 898-375-015	69.33	* 858-375-015	68.45	5	2.76	1.06
2	608	* 898-375-020	106.66	* 858-375-020	105.33	2	2.93	1.09

### Union (S x S)

- 150 psi @ 73°F (10.3 bar @ 22.7°C)

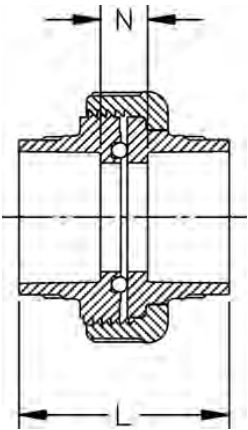

Size (inch)	P/L	EPDM Part No.	USD	FKM Part No.	USD	Pack Qty	L (inch)	N (inch)
3	608	* 897-030	110.45	* 857-030	111.84	1	4.74	0.96
4	608	* 897-040	152.78	* 857-040	155.78	1	5.62	1.11



### Union (FPT X FPT)

• 75 psi @ 73°F (5.2 bar @ 22.7°C)

Size (inch)	P/L	EPDM Part No.	USD	FKM Part No.	USD	Pack Qty	L (inch)	T (inch)
3	608	* 898-030	267.21	* 858-030	270.56	1	4.75	1.33
4	608	* 898-040	312.52	* 858-040	317.98	1	5.71	1.78

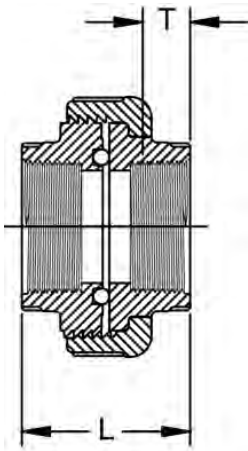

### Nipple (MPT x MPT)

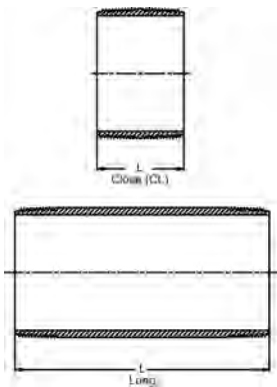

Size (inch)	P/L	Part No.	USD	Pack Qty	L (inch)	Design
1/2 x CL	608	* 861-077	5.39	50	1.13	MOLD
1/2 x 2	608	* 861-079	5.71	25	2.00	MOLD
1/2 x 3	608	* 861-081	6.64	25	3.00	MOLD
1/2 x 4	608	* 861-082	7.26	25	4.00	MOLD
1/2 x 5	608	* 861-083	8.81	25	5.00	MOLD
1/2 x 6	608	* 861-084	9.42	25	6.00	MOLD
1/2 x 8	608	* 861-086	11.07	25	8.00	FAB
1/2 x 10	608	* 861-087	12.95	25	10.00	FAB
1/2 x 12	608	* 861-088	14.73	25	12.00	FAB
3/4 x CL	608	* 861-104	5.71	25	1.38	MOLD
3/4 x 2	608	* 861-020	6.13	25	2.00	MOLD
3/4 x 3	608	* 861-106	6.85	25	3.00	MOLD
3/4 x 4	608	* 861-107	8.19	25	4.00	MOLD
3/4 x 5	608	* 861-108	9.72	25	5.00	MOLD
3/4 x 6	608	* 861-109	11.52	25	6.00	MOLD
3/4 x 8	608	* 861-110	13.39	25	8.00	FAB
3/4 x 10	608	* 861-111	15.86	25	10.00	FAB
3/4 x 12	608	* 861-112	18.02	25	12.00	FAB
1 x CL	608	* 861-133	8.19	25	1.50	MOLD
1 x 2	608	* 861-134	9.19	25	2.00	MOLD
1 x 3	608	* 861-135	10.16	25	3.00	MOLD
1 x 4	608	* 861-136	11.82	25	4.00	MOLD
1 x 5	608	* 861-137	14.73	25	5.00	MOLD
1 x 6	608	* 861-138	16.16	25	6.00	MOLD
1 x 8	608	* 861-139	19.20	25	8.00	FAB
1 x 10	608	* 861-140	22.94	25	10.00	FAB
1 x 12	608	* 861-141	25.51	25	12.00	FAB
1 1/4 x CL	608	* 861-170	10.38	25	1.63	MOLD
1 1/4 x 2	608	* 861-171	11.87	25	2.00	MOLD
1 1/4 x 3	608	* 861-172	13.39	25	3.00	MOLD
1 1/4 x 4	608	* 861-173	15.65	25	4.00	MOLD
1 1/4 x 5	608	* 861-174	18.45	25	5.00	MOLD
1 1/4 x 6	608	* 861-175	20.21	25	6.00	MOLD
1 1/4 x 8	608	* 861-176	24.58	25	8.00	FAB
1 1/4 x 10	608	* 861-177	28.53	25	10.00	FAB

table continued on the next page

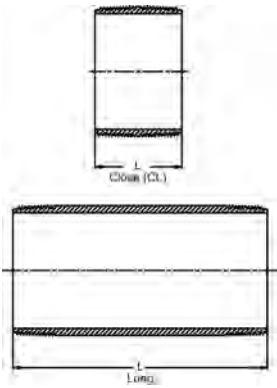

Size (inch)	P/L	Part No.	USD	Pack Qty	L (inch)	Design
1 1/4 x 12	608	* 861-178	32.05	25	12.00	FAB
1 1/2 x CL	608	* 861-213	12.95	25	1.75	MOLD
1 1/2 x 2	608	* 861-214	13.99	25	2.00	MOLD
1 1/2 x 3	608	* 861-215	16.16	25	3.00	MOLD
1 1/2 x 4	608	* 861-216	18.68	25	4.00	MOLD
1 1/2 x 5	608	* 861-217	21.55	25	5.00	MOLD
1 1/2 x 6	608	* 861-218	24.58	25	6.00	MOLD
1 1/2 x 8	608	* 861-219	29.24	25	8.00	FAB
1 1/2 x 10	608	* 861-220	33.79	25	10.00	FAB
1 1/2 x 12	608	* 861-221	36.31	25	12.00	FAB
2 x CL	608	* 861-251	17.12	25	2.00	MOLD
2 x 2 1/2	608	* 861-252	18.37	25	2.50	MOLD
2 x 3	608	* 861-253	20.21	25	3.00	MOLD
2 x 4	608	* 861-254	23.63	25	4.00	MOLD
2 x 5	608	* 861-255	27.67	25	5.00	MOLD
2 x 6	608	* 861-256	31.00	25	6.00	MOLD
2 x 8	608	* 861-257	37.83	25	8.00	FAB
2 x 10	608	* 861-258	44.79	25	10.00	FAB
2 x 12	608	* 861-259	51.21	25	12.00	FAB
2 1/2 x CL	608	* 861-291	52.19	10	2.50	FAB
2 1/2 x 4	608	* 861-295	67.93	10	4.00	FAB
2 1/2 x 3	608	* 861-292	60.11	10	3.00	FAB
2 1/2 x 5	608	* 861-296	76.73	10	5.00	FAB
2 1/2 x 6	608	* 861-297	85.99	10	6.00	FAB
2 1/2 x 8	608	* 861-298	104.24	10	8.00	FAB
2 1/2 x 10	608	* 861-299	122.18	10	10.00	FAB
2 1/2 x 12	608	* 861-300	140.41	10	12.00	FAB
3 x CL	608	* 861-338	62.42	10	2.63	FAB
3 x 3	608	* 861-340	69.45	10	3.00	FAB
3 x 4	608	* 861-341	79.41	10	4.00	FAB
3 x 5	608	* 861-342	90.75	10	5.00	FAB
3 x 6	608	* 861-343	101.93	10	6.00	FAB
3 x 8	608	* 861-344	124.65	10	8.00	FAB
3 x 10	608	* 861-345	147.36	10	10.00	FAB
3 x 12	608	* 861-346	169.95	10	12.00	FAB
4 x CL	608	* 861-422	102.44	10	2.88	FAB
4 x 4	608	* 861-423	107.84	10	4.00	FAB
4 x 5	608	* 861-425	119.99	10	5.00	FAB
4 x 6	608	* 861-426	133.56	10	6.00	FAB
4 x 8	608	* 861-427	162.09	5	8.00	FAB
4 x 10	608	* 861-428	192.47	5	10.00	FAB
4 x 12	608	* 861-429	221.94	5	12.00	FAB

# Schedule 80 PVC Low Pressure Fittings



## Tee Low Pressure (SxSxS)

- 130 psi @ 73°F (8.96 bar @ 22.7°C)

Size (inch)	P/L	Part No.	USD	Pack Qty	H (inch)	G (inch)
10	B11	H801100LP	Call	1	10.83	5.77
12	B11	H801120LP	Call	1	13.38	6.91

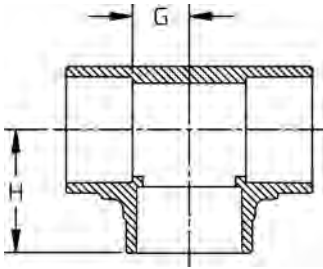

## 90° Ell Low Pressure (S x S)

- 130 psi @ 73°F (8.96 bar @ 22.7°C)

Size (inch)	P/L	Part No.	USD	Pack Qty	H (inch)	G (inch)
10	B11	H806100LP	Call	1	10.75	5.75
12	B11	H806120LP	Call	1	12.96	6.91

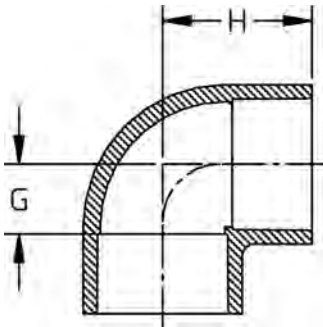

### 45° Ell Low Pressure (S x S)

- 130 psi @ 73°F (8.96 bar @ 22.7°C)



Size (inch)	P/L	Part No.	USD	Pack Qty	H (inch)	J (inch)
10	B11	<b>H817100LP</b>	Call	1	7.50	2.50
12	B11	<b>H817120LP</b>	Call	1	9.00	3.00

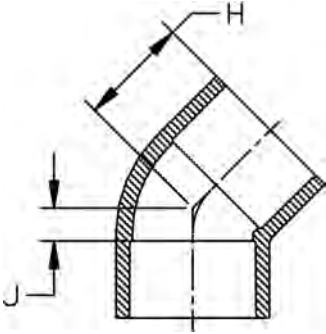

### Coupling Low Pressure (S x S)

- 130 psi @ 73°F (8.96 bar @ 22.7°C)



Size (inch)	P/L	Part No.	USD	Pack Qty	L (inch)	N (inch)
10	B11	<b>H829100LP</b>	Call	1	10.81	0.75
12	B11	<b>H829120LP</b>	Call	1	12.81	0.75

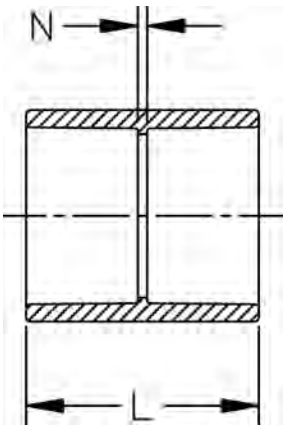



# Schedule 80 PVC DWV Fittings



## 1/4 Bend Short Sweep (SxS)

Size (inch)	P/L	Part No.	USD	Pack Qty	G (inch)
1 1/2	608	806-015SS	Call	4	1.75
2	608	806-020SS	Call	4	2.31
3	608	806-030SS	Call	1	3.06
4	608	806-040SS	Call	1	3.88

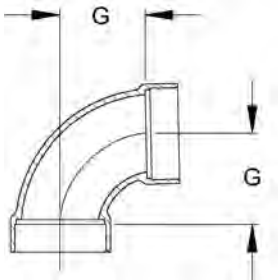

## 1/4 Bend Long Sweep (SxS) - FAB



Size (inch)	P/L	Part No.	USD	Pack Qty	G (inch)
1 1/2	A33	806-015LSN	Call	4	4.13
2	A33	806-020LSN	Call	4	4.75
3	A33	806-030LSN	Call	1	7.00
4	A33	806-040LSN	Call	1	9.00

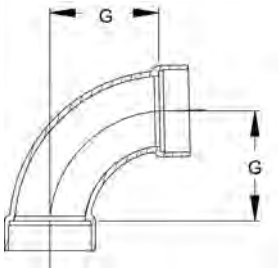

### 45° Wye (S x S x S)



1-1/2" - 2" 235 psi @ 72°F (16.2 bar @ 22.7°C)  
 3" - 6" 150 psi @ 72°F (10.3 bar @ 22.7°C)  
 8" - 24" 100 psi @ 72°F (6.9 bar @ 22.7°C)

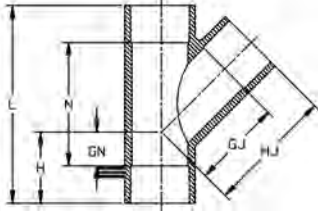

Size (inch)	P/L	Part No.	USD	Pack Qty	GJ (inch)	GN (inch)	H (inch)	HJ (inch)	L (inch)	N (inch)	Design
1 ½	608	* 870-015	39.09	20	2.79	1.20	2.60	4.18	6.80	4.02	SL
2	608	870-020	112.16	10	3.56	1.36	2.87	5.07	7.99	4.97	SL
2 ½	H02	* 870-025S	511.02	1	3.97	0.84	2.59	5.72	8.31	3.97	SL
3	608	870-030	360.54	4	4.91	1.82	3.73	6.83	10.45	6.62	SL
4	608	870-040	446.73	4	6.26	2.06	4.41	8.61	12.94	8.24	SL
6	608	870-060	610.15	2	8.38	1.85	4.90	11.44	16.50	10.39	HS
8	608	* 870-080	1,227.03	1	11.09	1.90	5.92	15.11	21.35	13.30	HS
10	A33	* 875-100N	1,483.64	1	19.75	5.50	11.25	24.75	31.75	21.75	FAB
12	A33	* 875-120N	1,885.77	1	22.63	6.50	12.50	28.63	37.50	25.50	FAB
14	A33	* 875-140N	3,149.51	1	25.75	7.00	14.00	32.75	41.75	27.75	FAB
16	A33	* 875-160N	4,137.26	1	28.88	7.75	16.00	36.88	47.25	31.25	FAB
18	A33	* 875-180N	4,638.43	1	32.50	8.50	17.50	41.50	53.00	35.00	FAB
20	A33	* 875-200N	6,196.05	1	35.50	9.50	19.50	45.50	58.75	38.75	FAB
24	A33	* 875-240N	8,246.15	1	42.00	11.00	23.00	54.00	70.00	46.00	FAB

### Reducing 45° Wye (S x S x S)



2" 235 psi @ 72°F (16.2 bar @ 22.7°C)  
 3" - 6" 150 psi @ 72°F (10.3 bar @ 22.7°C)  
 8" - 24" 100 psi @ 72°F (6.9 bar @ 22.7°C)

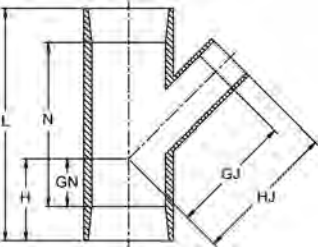

Size (inch)	P/L	Part No.	USD
2 x 1 ½	608	* 870-251FB	133.42
3 x 1 ½	608	* 870-337FB	420.24
3 x 2	608	* 870-338FB	420.24
4 x 2	608	* 870-420FB	528.35
4 x 3	608	* 870-422FB	528.35
6 x 2	608	* 870-528FB	452.39
6 x 3	608	* 870-530FB	575.28
6 x 4	608	870-532	465.00
8 x 3	608	* 870-580FB	1,524.89
8 x 4	608	870-582	1,605.15
8 x 6	608	* 870-585FB	1,497.32
10 x 4	A33	* 875-623N	1,094.78
10 x 6	A33	* 875-626N	1,245.77
10 x 8	A33	* 875-628N	1,440.75
12 x 4	A33	* 875-663N	1,381.48
12 x 6	A33	* 875-666N	1,575.54
12 x 8	A33	* 875-668N	1,726.04
12 x 10	A33	* 875-670N	1,829.14
14 x 4	A33	* 875-696N	1,709.67
14 x 6	A33	* 875-698N	1,809.20
14 x 8	A33	* 875-700N	1,850.93
14 x 10	A33	* 875-702N	2,066.55
14 x 12	A33	* 875-704N	2,342.23
16 x 4	A33	* 875-730N	1,862.02
16 x 6	A33	* 875-732N	1,870.09
16 x 8	A33	* 875-734N	2,110.55
16 x 10	A33	* 875-736N	2,375.94
16 x 12	A33	* 875-738N	2,588.67
16 x 14	A33	* 875-740N	2,997.84
18 x 4	A33	* 875-784N	3,342.69
18 x 6	A33	* 875-786N	3,774.49
18 x 8	A33	* 875-788N	3,914.69
18 x 10	A33	* 875-790N	4,207.55

table continued on the next page

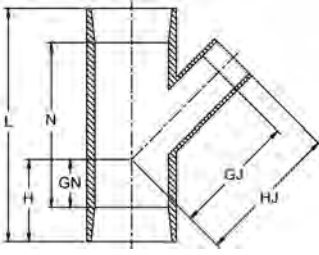

Size (inch)	P/L	Part No.	USD
18 x 12	A33	* 875-792N	4,223.59
18 x 14	A33	* 875-794N	4,561.68
18 x 16	A33	* 875-796N	4,593.84
20 x 4	A33	* 875-814N	4,130.69
20 x 6	A33	* 875-816N	4,451.11
20 x 8	A33	* 875-818N	4,703.82
20 x 10	A33	* 875-820N	4,863.14
20 x 12	A33	* 875-822N	5,037.78
20 x 14	A33	* 875-824N	5,438.41
20 x 16	A33	* 875-826N	5,888.49
20 x 18	A33	* 875-828N	6,112.20
24 x 4	A33	* 875-904N	5,139.18
24 x 6	A33	* 875-906N	5,315.99
24 x 8	A33	* 875-908N	5,452.06
24 x 10	A33	* 875-910N	5,698.79
24 x 12	A33	* 875-912N	6,061.02
24 x 14	A33	* 875-914N	6,296.12
24 x 16	A33	* 875-916N	6,717.05
24 x 18	A33	* 875-918N	7,746.13
24 x 20	A33	* 875-920N	8,108.98

Pack Qty	GJ (inch)	GN (inch)	H (inch)	HJ (inch)	L (inch)	N (inch)	Design
10	3.96	1.36	2.87	5.37	7.99	4.97	BUSH
4	5.80	1.82	3.73	7.34	10.45	6.62	BUSH
4	5.77	1.82	3.73	7.33	10.45	6.62	BUSH
4	7.40	2.06	4.41	7.40	12.94	8.24	BUSH
4	7.03	2.06	4.41	9.00	12.94	8.24	BUSH
2	8.24	1.87	4.91	8.24	16.49	10.42	BUSH
2	7.88	1.87	4.91	9.84	16.49	10.42	BUSH
2	7.14	1.87	4.91	9.36	16.49	10.42	HS
1	10.23	0.41	4.43	12.20	15.98	7.95	BUSH
1	9.46	0.41	4.43	11.73	15.98	7.95	HS
1	12.78	1.90	5.92	15.76	21.35	13.30	BUSH
1	14.00	1.25	6.25	16.00	23.00	13.00	FAB
1	16.13	2.75	7.50	19.13	26.00	16.00	FAB
1	17.50	4.00	9.25	21.50	28.00	18.75	FAB
1	15.50	0.50	6.00	17.50	25.75	13.75	FAB
1	16.68	2.00	8.00	20.50	28.68	16.68	FAB
1	19.00	3.50	9.50	23.00	31.50	19.50	FAB
1	21.25	5.00	11.00	26.25	34.50	22.50	FAB
1	16.25	0.25	7.25	18.25	28.25	14.25	FAB
1	18.50	1.75	8.63	21.50	31.25	17.25	FAB
1	19.75	3.00	10.00	23.75	34.00	20.00	FAB
1	22.00	4.50	11.50	27.00	37.00	23.00	FAB
1	23.50	6.00	13.00	29.50	39.75	25.75	FAB
1	17.75	-0.75	7.50	19.75	31.00	15.00	FAB
1	19.88	1.00	9.00	22.88	34.00	18.00	FAB
1	21.25	2.50	10.25	25.25	36.75	20.75	FAB
1	23.50	4.00	12.00	28.50	39.75	23.75	FAB
1	25.00	5.50	14.25	31.00	42.75	26.75	FAB
1	27.25	6.25	14.25	34.25	44.50	28.50	FAB
1	19.00	-1.25	8.00	21.00	34.00	16.00	FAB
1	21.25	0.50	9.50	24.25	37.00	19.00	FAB
1	22.75	2.00	11.00	26.75	39.75	21.75	FAB
1	25.00	3.50	12.50	30.00	42.75	24.75	FAB
1	26.25	4.75	13.75	32.50	45.50	27.50	FAB
1	28.75	5.75	14.75	35.75	47.50	29.50	FAB
1	30.25	7.25	16.00	38.25	50.25	32.25	FAB
1	20.50	-1.75	8.50	22.50	36.75	16.75	FAB
1	22.75	-0.25	10.00	25.75	39.75	19.75	FAB
1	24.25	1.50	11.50	28.25	42.75	22.75	FAB
1	26.50	3.00	13.00	31.50	45.75	25.75	FAB

table continued on the next page

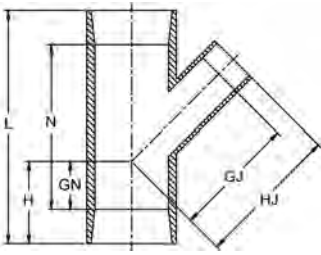

Pack Qty	GJ (inch)	GN (inch)	H (inch)	HJ (inch)	L (inch)	N (inch)	Design
1	28.00	4.25	14.25	34.00	48.50	28.50	FAB
1	30.25	5.25	15.00	37.25	50.25	30.25	FAB
1	31.75	6.50	16.50	39.75	53.00	33.00	FAB
1	34.00	8.00	18.00	43.00	56.00	36.00	FAB
1	23.25	-3.00	9.25	25.25	42.50	18.50	FAB
1	25.50	-1.50	10.75	28.50	45.50	21.54	FAB
1	27.00	0.00	12.00	31.00	48.25	24.25	FAB
1	29.25	1.75	13.50	34.25	51.25	27.25	FAB
1	30.50	3.25	15.00	36.50	54.25	30.25	FAB
1	33.00	4.00	16.00	40.00	56.00	32.00	FAB
1	34.50	5.50	17.50	42.50	58.75	34.75	FAB
1	36.75	6.75	18.75	45.75	61.50	37.50	FAB
1	38.25	8.25	20.25	48.25	64.50	40.50	FAB



### Sanitary Tee (SxSxS)

Size (inch)	P/L	Part No.	USD	Pack Qty	G (inch)	N (inch)
1 1/2	608	<b>37R461501</b>	Call	5	1.75	2.75
2	608	<b>37R461502</b>	Call	5	2.31	3.69
3	608	<b>37R461503</b>	Call	5	3.06	4.88
4	608	<b>37R461504</b>	Call	5	3.88	6.13

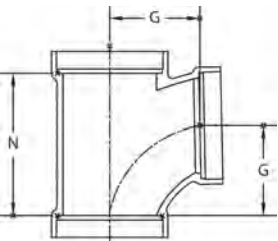

### Cleanout Tee with Plug (SxSxFPT)

Size (inch)	P/L	Part No.	USD	Pack Qty	HL (inch)	N (inch)
1 1/2	608	<b>37R461101</b>	Call	2	2.07	1.80
2	608	<b>37R461102</b>	Call	2	2.35	2.32
3	608	<b>37R461103</b>	Call	2	3.51	3.63
4	608	<b>37R461104</b>	Call	2	4.07	4.25

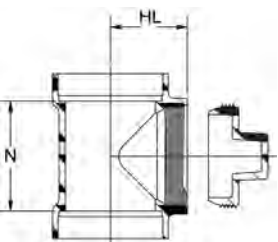

# Schedule 80 PVC Metal Transition Fittings

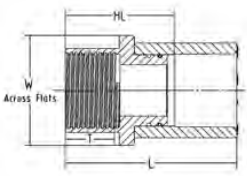

## PVC-to-316SS Female Adapter (SxFPT)

Size (inch)	P/L	Part No.	USD	Pack Qty	HL (inch)	L (inch)	T (inch)	W (inch)
½	A35	<b>868-005</b>	Call	25	1.49	2.38	0.84	1.25
¾	A35	<b>868-007</b>	Call	20	1.67	2.68	0.92	1.50
1	A35	<b>868-010</b>	Call	25	1.98	3.11	0.96	1.75
1 ¼	A35	<b>868-012</b>	Call	10	2.19	3.45	1.04	2.12
1 ½	A35	<b>868-015</b>	Call	10	2.35	3.73	1.04	2.50
2	A35	<b>868-020</b>	Call	5	2.63	4.14	1.29	3.00

## PVC-to-316SS Male Adapter (SxMPT)

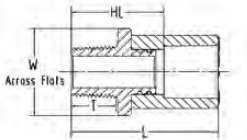
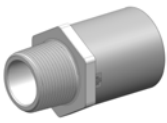

Size (inch)	P/L	Part No.	USD	Pack Qty	HL (inch)	L (inch)	T (inch)	W (inch)
½	A35	<b>869-005</b>	Call	50	1.49	2.38	0.70	1.25
¾	A35	<b>869-007</b>	Call	25	1.67	2.68	0.74	1.50
1	A35	<b>869-010</b>	Call	25	1.98	3.11	0.92	1.75
1 ¼	A35	<b>869-012</b>	Call	15	2.19	3.45	0.95	2.12
1 ½	A35	<b>869-015</b>	Call	15	2.35	3.73	0.99	2.50
2	A35	<b>869-020</b>	Call	5	2.64	4.14	1.03	3.00

\*

## Metal Union End Connectors Type 375 (316 SS)

150 psi @ 73°F (10.3 bar @ 22.7°C)  
Union Sold Separately



Size (inch)	P/L	Part No.	USD	Pack Qty
½	A35	<b>* 37X003314</b>	<b>146.19</b>	1
¾	A35	<b>* 37X003315</b>	<b>190.39</b>	1
1	A35	<b>* 37X003316</b>	<b>215.36</b>	1
1 ¼	A35	<b>* 37X003317</b>	<b>444.98</b>	1
1 ½	A35	<b>* 37X003318</b>	<b>463.53</b>	1
2	A35	<b>* 37X003319</b>	<b>698.85</b>	1

### PVC-to-Brass Transition Fittings (SPG x FPT)

150 psi @ 73°F (10.3 bar @ 22.7°C)



Size (inch)	P/L	Part No.	USD	Pack Qty	HL (inch)	L (inch)	T (inch)	W (inch)
½	A35	<b>878-005BR</b>	<b>27.66</b>	25	1.02	1.75	0.70	1.27
¾	A35	<b>878-007BR</b>	<b>39.74</b>	15	1.07	2.07	0.74	1.52
1	A35	<b>878-010BR</b>	<b>68.47</b>	15	1.32	2.44	0.81	1.93
1 ¼	A35	<b>878-012BR</b>	<b>112.77</b>	15	1.38	2.49	0.85	2.29
1 ½	A35	<b>878-015BR</b>	<b>148.14</b>	10	1.44	2.74	0.87	2.60
2	A35	<b>878-020BR</b>	<b>183.48</b>	5	1.43	2.81	1.11	3.36

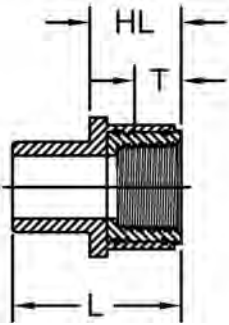
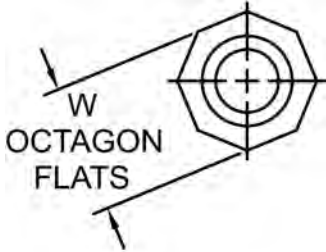

### PVC-to-316 SS Transition Fittings (SPG x FPT)

150 psi @ 73°F (10.3 bar @ 22.7°C)



Size (inch)	P/L	Part No.	USD	Pack Qty	HL (inch)	L (inch)	T (inch)	W (inch)
½	A35	<b>878-005SS</b>	<b>54.22</b>	25	1.02	1.75	0.70	1.27
¾	A35	<b>878-007SS</b>	<b>77.92</b>	15	1.07	2.07	0.74	1.52
1	A35	<b>878-010SS</b>	<b>132.58</b>	15	1.32	2.44	0.81	1.93
1 ¼	A35	<b>878-012SS</b>	<b>221.42</b>	15	1.38	2.49	0.85	2.29
1 ½	A35	<b>878-015SS</b>	<b>289.24</b>	10	1.45	2.74	0.87	2.60
2	A35	<b>878-020SS</b>	<b>371.04</b>	5	1.43	2.81	1.11	3.36

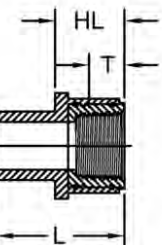
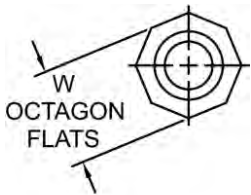

# Schedule 80 PVC Expansion Joints

## Expansion Joint 6" Travel (S x S)

To order SxSPG add "P" to end of part number.  
To order FxF add "F" to end of part number.

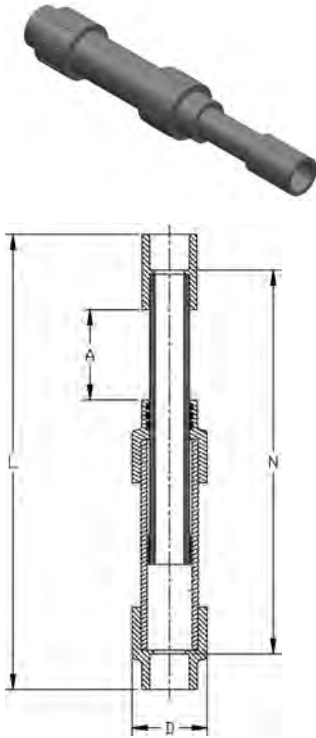

Size (inch)	P/L	EPDM Part No.	USD	FKM Part No.	USD	A (inch)	D (inch)	L (inch)	N (inch)
1/2	634	* 826-005X6	346.85	* 836-005X6	381.54	3.00	1.86	13.97	12.17
3/4	634	* 826-007X6	372.87	* 836-007X6	410.16	3.00	2.23	14.44	12.40
1	634	* 826-010X6	377.07	* 836-010X6	414.78	3.00	2.50	14.98	12.69
1 1/4	634	* 826-012X6	438.28	* 836-012X6	482.12	3.00	2.89	15.56	12.98
1 1/2	634	* 826-015X6	464.75	* 836-015X6	511.22	3.00	3.51	16.00	13.21
2	634	* 826-020X6	519.86	* 836-020X6	571.85	3.00	4.40	18.05	15.01
3	634	* 826-030X6	615.53	* 836-030X6	677.07	3.00	5.52	19.75	16.00
4	634	* 826-040X6	660.58	* 836-040X6	726.63	3.00	7.92	28.29	23.76
6	634	* 826-060X6	1,088.31	* 836-060X6	1,197.14	3.00	9.80	27.79	21.73
8	634	* 826-080X6	1,498.29	* 836-080X6	1,648.13	3.00	10.75	25.35	17.31
10	634	* 826-100X6	1,759.42	* 836-100X6	1,935.37	3.00	12.75	29.64	19.60

## Expansion Joint 12" Travel (S x S)

To order SxSPG add "P" to end of part number.  
To order FxF add "F" to end of part number.

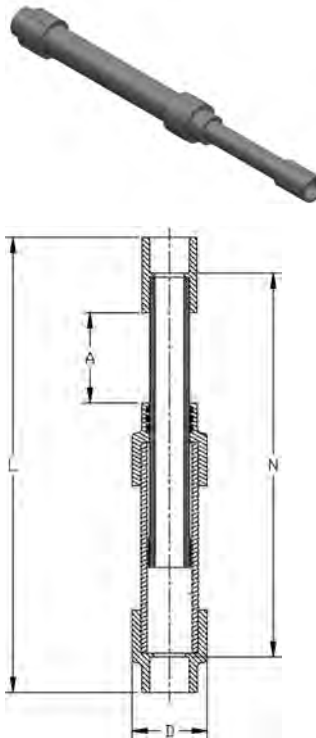

Size (inch)	P/L	EPDM Part No.	USD	FKM Part No.	USD	A (inch)	D (inch)	L (inch)	N (inch)
1/2	634	* 826-005X12	390.15	* 836-005X12	429.17	6.00	1.86	23.10	21.30
3/4	634	* 826-007X12	412.62	* 836-007X12	453.88	6.00	2.23	23.57	21.52
1	634	* 826-010X12	494.45	* 836-010X12	543.89	6.00	2.50	24.11	21.81
1 1/4	634	* 826-012X12	540.24	* 836-012X12	594.26	6.00	2.89	24.69	22.11
1 1/2	634	* 826-015X12	500.58	* 836-015X12	550.63	6.00	3.51	25.12	22.34
2	634	* 826-020X12	590.49	* 836-020X12	649.55	6.00	4.40	27.05	24.01
3	634	* 826-030X12	762.86	* 836-030X12	839.15	6.00	5.52	28.75	25.00
4	634	* 826-040X12	857.00	* 836-040X12	942.69	6.00	7.92	37.28	32.76
6	634	* 826-060X12	1,248.40	* 836-060X12	1,373.24	6.00	9.80	26.79	30.73
8	634	* 826-080X12	1,673.73	* 836-080X12	1,841.11	6.00	10.75	28.35	20.31
10	634	* 826-100X12	2,046.25	* 836-100X12	2,250.87	6.00	12.75	32.64	22.60